

Do not scale this drawing (printed or electronic version).
 Contractors must check all dimensions from site.
 This drawing is copyright and is for use on this site only. This drawing should be read in conjunction with all relevant consultants drawings and specialist subcontractors / supply chain drawings and specifications.
 All works to be carried out in accordance with the latest British Standards / Codes of Practice unless specifically directed otherwise in the specification.
 Responsibility for the reproduction of this drawing in paper form, or issued in electronic format, lies with the recipient to check that all information has been replicated in full and is correct when compared to the original paper or electronic image.
 Graphical representations of equipment on this drawing have been co-ordinated, but are approximations only. Please refer to the specifications and / or details for actual sizes and / or specific contractor construction information.

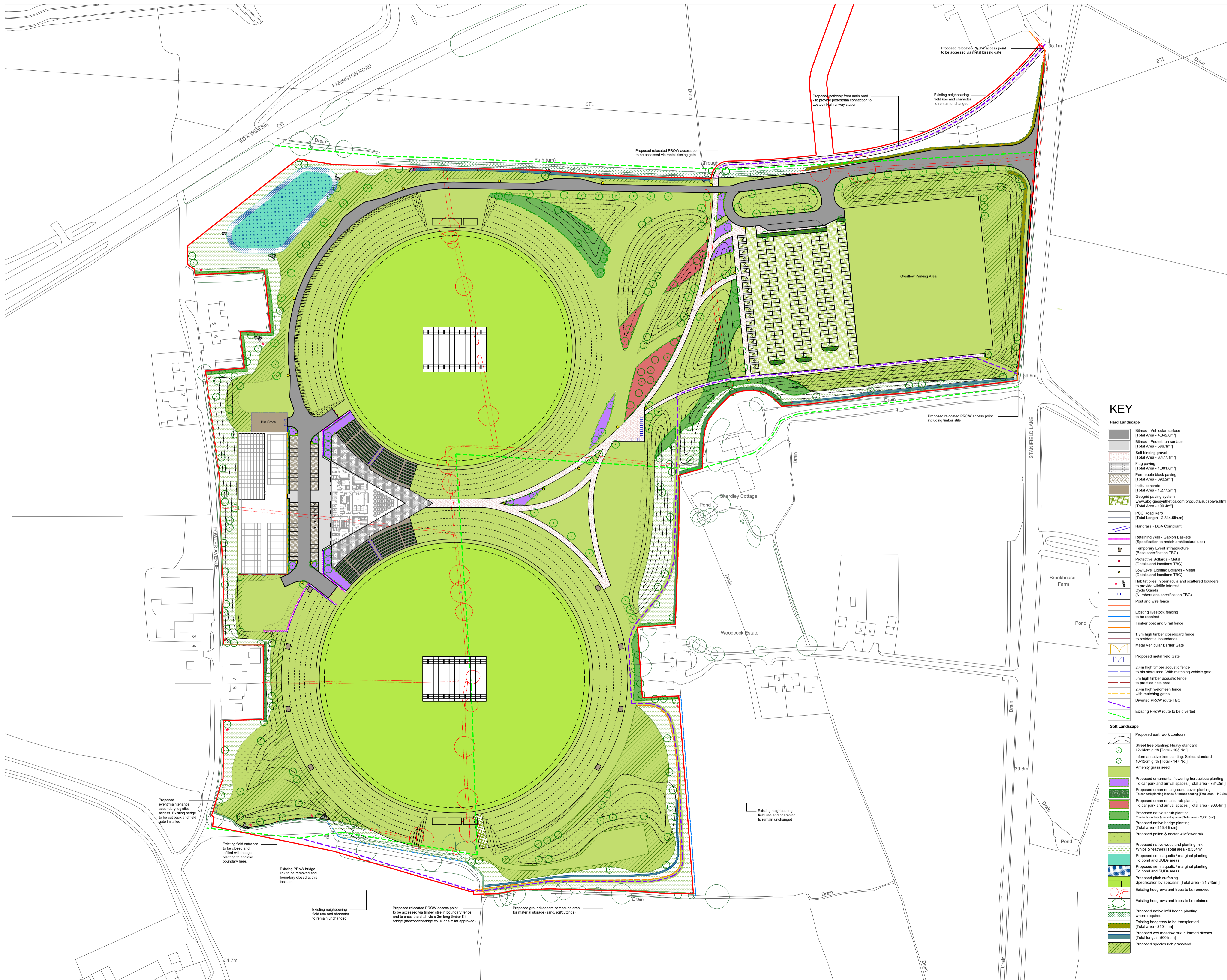
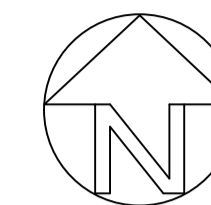

KEY

Hard Landscapes

- Bitmac - Vehicular surface [Total Area - 4,842.0m²]
- Bitmac - Pedestrian surface [Total Area - 586.1m²]
- Self binding gravel [Total Area - 3,477.1m²]
- Flag paving [Total Area - 1,001.8m²]
- Permeable block paving [Total Area - 692.2m²]
- Mass concrete [Total Area - 1,277.2m²]
- Geogrid paving system www.abp-geosynthetics.com/products/subspave.html [Total Area - 100.4m²]
- PCC Road Kerb [Total Length - 2,344.6lin.m]
- Handrails - DDA Compliant
- Retaining Wall - Gabion Baskets (Specification to match architectural use)
- Temporary Event Infrastructure (Base specification TBC)
- Protective Bollards - Metal (Details and locations TBC)
- Low Level Lighting Bollards - Metal (Details and locations TBC)
- Habitat piles, hibernacula and scattered boulders to provide wildlife interest
- Cycle Stands (Numbers and specification TBC)
- Post and wire fence
- Existing livestock fencing to be retained
- Timber post and 3 rail fence
- 1.3m high timber closeboard fence to residential boundaries
- Metal Vehicular Barrier Gate
- Proposed metal field Gate
- 2.4m high timber acoustic fence to bore area. With matching vehicle gate
- 5m high timber acoustic fence to practice nets area
- 2.4m high waist-high fence with matching gates
- Diverted PROW route TBC
- Existing PROW route to be diverted

Soft Landscapes

- Proposed earthwork contours
- Street tree planting: Heavy standard 12-14cm girth [Total - 103 No.]
- Informal native tree planting: Select standard 10-12cm girth [Total - 147 No.]
- Amenity grass seed
- Proposed ornamental flowering herbaceous planting To car park and arrival spaces [Total area - 784.2m²]
- Proposed ornamental ground cover planting To car park paving islands & terrace seating [Total area - 442.2m²]
- Proposed ornamental shrub planting To car park and arrival spaces [Total area - 903.4m²]
- Proposed native shrub planting To site boundary & arrival spaces [Total area - 2,221.5m²]
- Proposed native hedge planting [Total area - 313.4 lin.m]
- Proposed pollen & nectar wildflower mix
- Proposed native woodland planting mix Whips & leathers [Total area - 8,334m²]
- Proposed semi aquatic / marginal planting To pond and SUDs areas
- Proposed semi aquatic / marginal planting To pond and SUDs areas
- Proposed pitch surfacing Specification by specialist [Total area - 31,745m²]
- Existing hedgrows and trees to be removed
- Existing hedgrows and trees to be retained
- Proposed native infill hedge planting where required
- Existing hedgerow to be transplanted [Total area - 210lin.m]
- Proposed wet meadow mix in formed ditches [Total length - 500lin.m]
- Proposed species rich grassland

REV.	DATE	DESCRIPTION	DRAWN	CHK'D
P22	04/10/22	AMENDED ISSUE	SA	ME
P21	23/09/22	AMENDED ISSUE	SA	ME
P20	21/07/22	AMENDED ISSUE	SA	ME
P19	20/07/22	AMENDED ISSUE	SA	ME
P18	20/07/22	AMENDED ISSUE	SA	ME
P17	20/07/22	AMENDED ISSUE	SA	ME
P16	19/07/22	AMENDED ISSUE	SA	ME

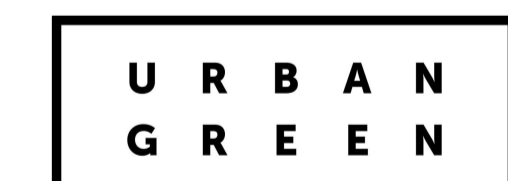

A: Ground Floor, The Tower,
 Deva City Office Park, Trinity Way,
 Manchester M3 7BF
 T: +44 (0) 161 312 3131
 weareurbangreen.co.uk

Client: **ERIC WRIGHT**

Project: **CRICKET FACILITY, FARINGTON**

Title: **GENERAL ARRANGEMENT PLANNING**

Issue:

Drawn: RS	Checked: SA	Approved: MT
Project: UG1016	Scale @ A1: 1:1000	Date: 09/08/21
Dwg No: UG_1016_LAN_GA_DRW_01	Revision: P22	