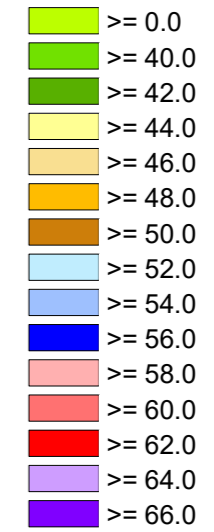



**Figure B3: Proposed Cricket Facility, Farington
Typical Day**

Predicted LAeq,1hour dBA
Typical Worst Case



Notes:

Typical Existing Daytime LAeq,t = 52dBA
Typical Existing Daytime LA90 = 49dBA

Based on noise sources operating simultaneously all occurrences taking place during 1 hour assessment period however these may actually take place during different periods throughout the day resulting in lower levels than predicted.

See Appendix B for activity assumptions.



Red Acoustics Ltd
Unit 8 Cable Court, Pittman Way, Prestron PR2 9YW
www.redacoustics.co.uk
t: 01772 722182 e: info@redacoustics.co.uk

Figure B4: Proposed Cricket Facility, Farington

Typical Prematch

Predicted LAeq,1hour dBA
Typical Worst Case

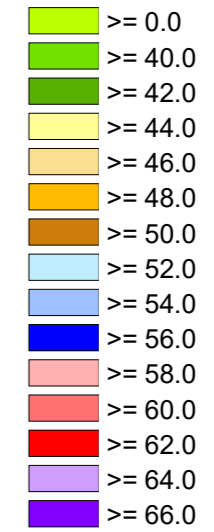
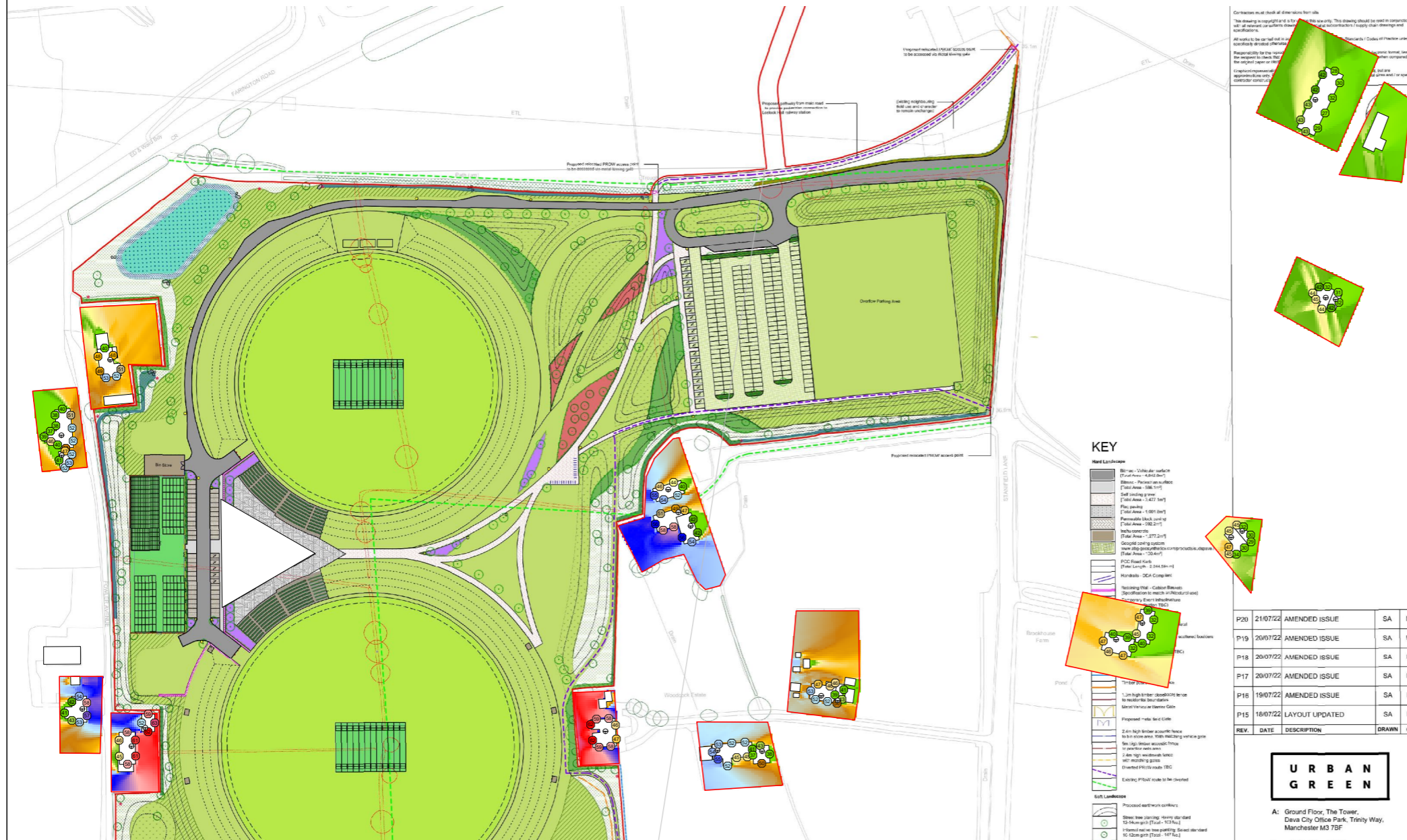

Notes:

Typical Existing Daytime LAeq,t = 52dBA
Typical Existing Daytime LA90 = 49dBA

Based on noise sources operating simultaneously all occurrences taking place during 1 hour assessment period however these may actually take place during different periods throughout the day resulting in lower levels than predicted.

See Appendix B for activity assumptions.

REV.	DATE	DESCRIPTION	DRAWN	CHKD
P20	21/07/22	AMENDED ISSUE	SA	ME
P19	20/07/22	AMENDED ISSUE	SA	ME
P18	20/07/22	AMENDED ISSUE	SA	ME
P17	20/07/22	AMENDED ISSUE	SA	ME
P16	19/07/22	AMENDED ISSUE	SA	ME
P15	16/07/22	LAYOUT UPDATED	SA	ME



A: Ground Floor, The Tower,
Deva City Office Park, Trinity Way,
Manchester M3 7BF



Red Acoustics Ltd
Unit 8 Cable Court, Pittman Way, Prestron PR2 9YW
www.redacoustics.co.uk
t: 01772 722182 e: info@redacoustics.co.uk