

Planting Schedule - Green Infrastructure Zone C

Trees	Number	Species	Girth	Specification
	8	Populus tremula	14-16cm	Extra Heavy Standard
	4	Tilia cordata	14-16cm	Extra Heavy Standard
	Total :12			

Woodland Mix

Number	Abbreviation	Species	Specification	Density	Percentage Contribution
50	Ac	Acer campestre	2Ctr	5%	
31	Aps	Acer pseudoplatanus	2Ctr	3%	
50	Ag	Alnus glutinosa	2Ctr	5%	
68	Bp	Betula pendula	2Ctr	7%	
290	Cav	Corylus avellana	2Ctr	30%	
40	Cmo	Crataegus monogyna	2Ctr	4%	
50	FRAAL	Frangula alnus	2Ctr	5%	
68	Ia	Ilex aquifolium	2Ctr	7%	
31	Msv	Malus sylvestris	2Ctr	3%	
50	Pav	Prunus avium	2Ctr	5%	
50	Ppa	Prunus padus	2Ctr	5%	
50	Psp	Prunus spinosa	2Ctr	5%	
98	Qpe	Quercus petraea	2Ctr	10%	
11	Rca	Rosa canina	Locate to edges	2Ctr	1%
50	Vop	Viburnum opulus	Locate to edges	2Ctr	5%
	Total :987				

Woodland Mix

43	No. Acer campestre
26	No. Acer pseudoplatanus
45	No. Alnus glutinosa
59	No. Betula pendula
253	No. Corylus avellana
54	No. Crataegus monogyna
59	No. Frangula alnus
43	No. Ilex aquifolium
26	No. Malus sylvestris
43	No. Prunus avium
43	No. Prunus padus
85	No. Quercus petraea
9	No. Rosa canina
43	No. Viburnum opulus

EPI - Pond Edge Mixture

Wildflowers	Latin Name
%	Achillea millefolium
	Agrostis capillaris
	Angelica sylvestris
	Centaurea nigra
	Cherophyllum temulum
	Crucifera leucophaea
	Dipsacus fullonum
	Filipendula ulmaria
	Gallium album - (Gallium molluga)
	Gallium verum
	Leucanthemum vulgare
	Lythrum salicaria
	Malva moschata
	Plantago lanceolata
	Rumex acetosa
	Silium silaus
20	

Grasses

Latin Name	
%	Agrostis capillaris
	Anthoxanthum odoratum
	Beta media
	Cynosurus cristatus
	Deschampsia cespitosa
	Festuca rubra
80	

EMM - Meadow Mixture for Clay Soils

Wildflowers	Latin Name
%	2.5 Agrimonia eupatoria
	0.1 Angelica sylvestris
	1.5 Betonica officinalis - (Stachys officinalis)
	3 Centaurea nigra
	1.5 Filipendula ulmaria
	0.2 Leontodon hispidus
	2 Leucanthemum vulgare
	0.5 Lotus corniculatus
	1 Malva moschata
	2.5 Plantago lanceolata
	0.2 Prunella vert
	1 Prunella vulgaris
	0.5 Ranunculus acris
	0.5 Silium silaus
	3 Vicia cracca
20	

Grasses

Latin Name	
%	10 Agrostis capillaris
	2 Anthoxanthum odoratum
	5 Beta media
	2 Carex flacca
	35 Cynosurus cristatus
	24 Festuca rubra
	2 Trisetum
80	

*Sow at 6g/m2

DESIGN RISK: PROJECT-SPECIFIC SIGNIFICANT RISKS

#	Hazard/Risk	Mitigation/ Residual Risk
1	-	-
2	-	-
3	-	-
4	-	-
5	-	-

KEY - SOFT LANDSCAPING

- Grass
- Proposed shrub mix
- Existing hedge
- Proposed native hedge
- Existing vegetation
- Proposed tree heavy standard 12-14cm girth
- Proposed tree extra heavy standard 14-16cm girth
- Proposed woodland mix
- Proposed wildflower
- Bankments
- Existing PROW unaffected
- Existing PROW to be diverted / stopped up
- Proposed PROW
- Controlled footpath / access for VOVA
- Proposed permissive PROW

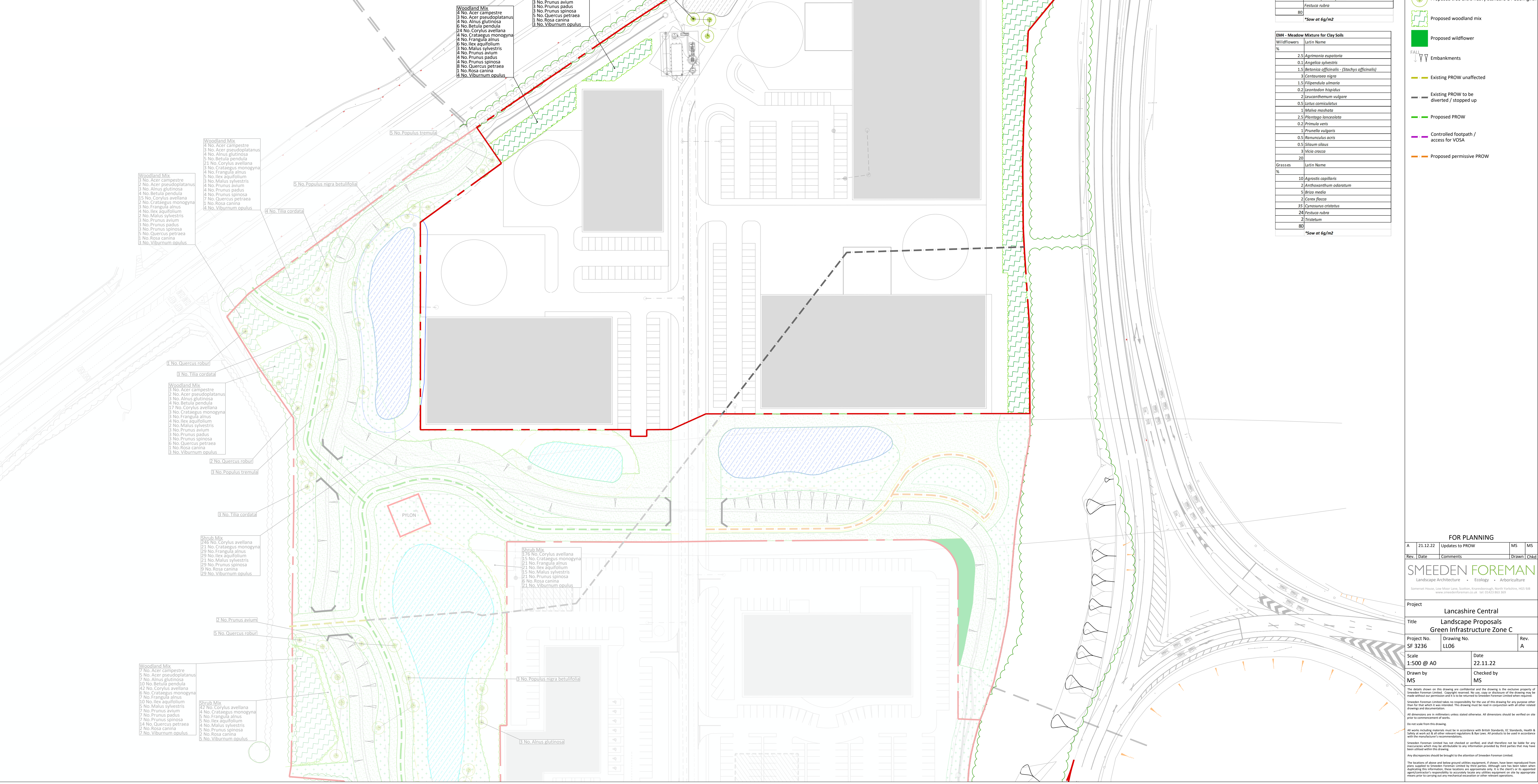
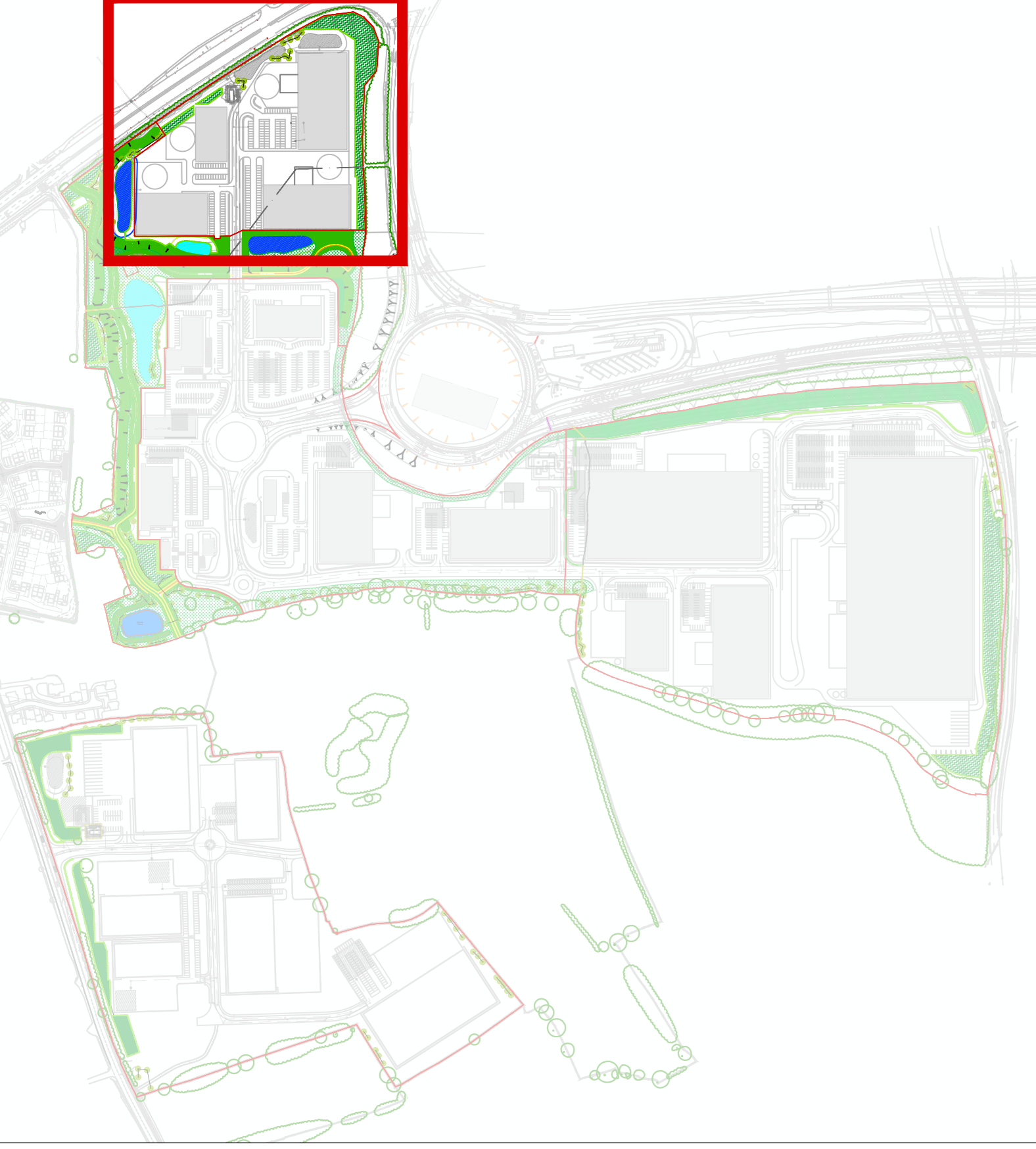

Woodland Mix

3	No. Acer campestre
3	No. Acer pseudoplatanus
3	No. Alnus glutinosa
4	No. Betula pendula
2	No. Crataegus monogyna
3	No. Corylus avellana
3	No. Frangula alnus
4	No. Ilex aquifolium
2	No. Malus sylvestris
3	No. Prunus avium
3	No. Prunus padus
3	No. Prunus spinosa
5	No. Quercus petraea
1	No. Rosa canina
3	No. Viburnum opulus

Woodland Mix

3	No. Acer campestre
2	No. Acer pseudoplatanus
3	No. Alnus glutinosa
4	No. Betula pendula
2	No. Crataegus monogyna
3	No. Corylus avellana
3	No. Frangula alnus
4	No. Ilex aquifolium
2	No. Malus sylvestris
3	No. Prunus avium
3	No. Prunus padus
3	No. Prunus spinosa
5	No. Quercus petraea
1	No. Rosa canina
3	No. Viburnum opulus

Shrub Mix

24	No. Corylus avellana
3	No. Malus sylvestris
7	No. Prunus avium
7	No. Prunus padus
7	No. Prunus spinosa
4	No. Quercus petraea
2	No. Rosa canina
7	No. Viburnum opulus

Woodland Mix

7	No. Acer campestre
5	No. Acer pseudoplatanus
7	No. Alnus glutinosa
10	No. Betula pendula
62	No. Corylus avellana
6	No. Crataegus monogyna
17	No. Frangula alnus
10	No. Ilex aquifolium
3	No. Malus sylvestris
7	No. Prunus avium
7	No. Prunus padus
7	No. Prunus spinosa
14	No. Quercus petraea
2	No. Rosa canina
7	No. Viburnum opulus

Shrub Mix

17	No. Corylus avellana
15	No. Crataegus monogyna
21	No. Frangula alnus
15	No. Ilex aquifolium
21	No. Malus sylvestris
21	No. Prunus spinosa
6	No. Rosa canina
21	No. Viburnum opulus

FOR PLANNING

Rev.	Date	Comments	MS	MS
A	21.12.22	Updates to PROW		

SMEEDEN FOREMAN
Landscape Architecture • Ecology • Arboriculture

Project: Lancashire Central
Title: Landscape Proposals Green Infrastructure Zone C

Project No. SF 3236 | Drawing No. L106 | Date 22.11.22 | Rev. A

Scale: 1:500 @ A0 | Drawn by MS | Checked by MS

The details shown on this drawing are confidential and the drawing is the exclusive property of Smeeden Foreman Limited. Copyright reserved. No use, copy or disclosure of the drawing may be made without our permission and to be returned to Smeeden Foreman Limited when required. Smeeden Foreman Limited takes no responsibility for the use of this drawing for any purpose other than that for which it was intended. This drawing must be read in conjunction with all other related drawings and documentation. All dimensions are in millimetres unless stated otherwise. All dimensions should be verified on site prior to commencement of works. Do not scale from this drawing. All works including materials must be in accordance with British Standards, EC Standards, Health & Safety at work act & all other relevant regulations & Part Laws. All products to be used in accordance with the manufacturer's recommendations. Smeeden Foreman Limited has not checked or verified, and shall therefore not be liable for any inaccuracies which may be attributable to any information provided by third parties that may have been utilised within this drawing. Any discrepancies should be brought to the attention of Smeeden Foreman Limited. The locations of above and below ground utilities equipment, if shown, have been reproduced from plans supplied to Smeeden Foreman Limited by third parties, although they have been checked and verified. This information is approximate only, it is the client's or its appointed specialist's responsibility to accurately locate any utilities equipment on site. An appropriate means prior to carrying out any mechanical excavation or other relevant operations.