

File name \\UK.WSPGROUP.COM\CENTRAL DATA\PROJECTS\0084465-XX-DR-005-007 REV A.DWG, printed on 09 December 2022 15:24:57, by Johnstone, Harry

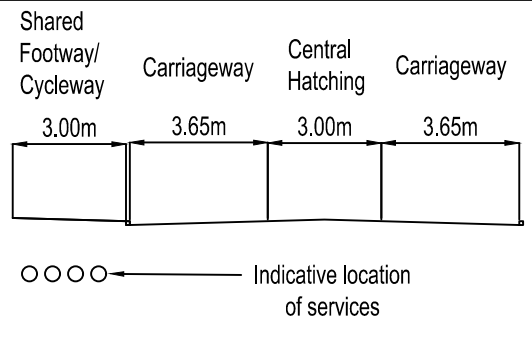
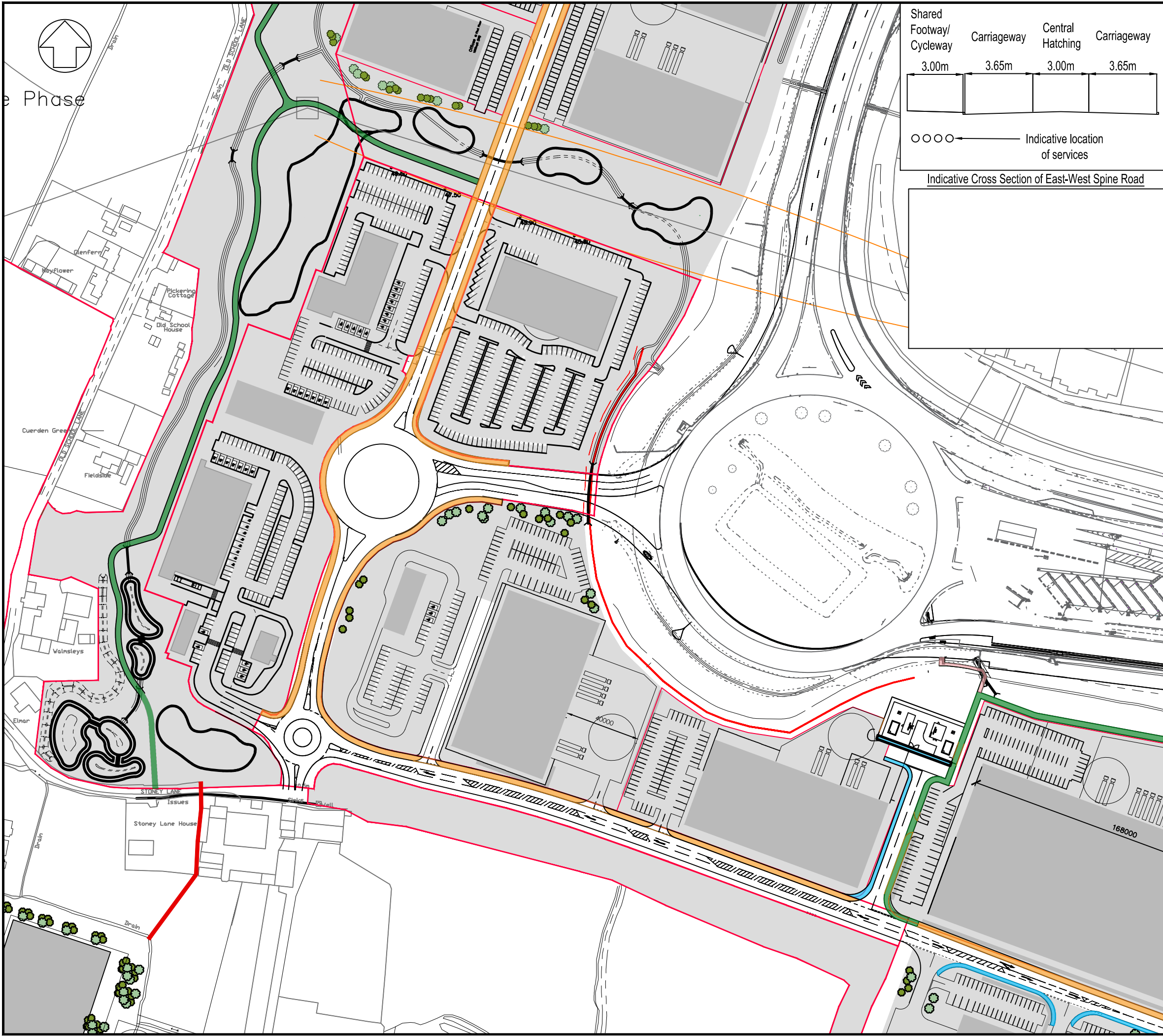

Indicative Cross Section of East-West Spine Road

DO NOT SCALE

NOTES

- Route between M65 terminus and Wigan Road (via Phase A and B) to be offered for adoption. Route between M65 terminus and Stanifield Lane (via Phase A, Future Phase and Phase D) to be offered for adoption at a future time when future phase of development and through vehicle route is completed

KEY

- 3m Shared Footway/Cycleway
- Public Right of Way
- Proposed Footway
- Existing Footway

| REV | DATE | BY | DESCRIPTION | CHK | APP |
|-----|------------|----|------------------------------|-----|-----|
| P03 | 15/11/2022 | DR | EAST WEST SPINE ROAD AMENDED | HP | |
| P02 | 11/11/2022 | DR | AMENDED TO SUIT LCC PROW | HP | |
| P01 | 10/11/2022 | DR | FIRST ISSUE | HP | |

DRAWING STATUS: **S0 - WORK IN PROGRESS**

First Street, Manchester, M15 4RP, UK
T+ 44 (0) 161 200 5000
wsp.com

CLIENT: **MAPLE GROVE DEVELOPMENTS**

ARCHITECT: **FLETCHER RAE**

PROJECT: **LANCASHIRE CENTRAL, CUERDEN**

TITLE: **HIGHWAYS LAYOUT SHEET 1 OF 3 INDICATIVE ONLY**

SCALE @ A3: 1:2000 CHECKED: APPROVED:

PROJECT No: 70084465 DESIGNED: DRAWN: HJ DATE: December 22

DRAWING No: 84465-WSP-XX-DR-005 REV: P03

© WSP UK Ltd