

File name \\UK.WSPGROUP.COM\CENTRAL DATA\PROJECTS\0084465-XX-DR-005-007 REV A.DWG, printed on 09 December 2022 15:30:11, by Johnstone, Harry

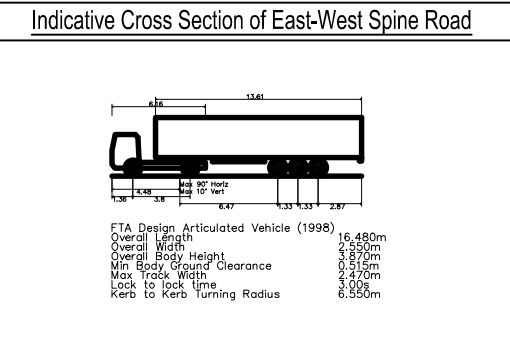
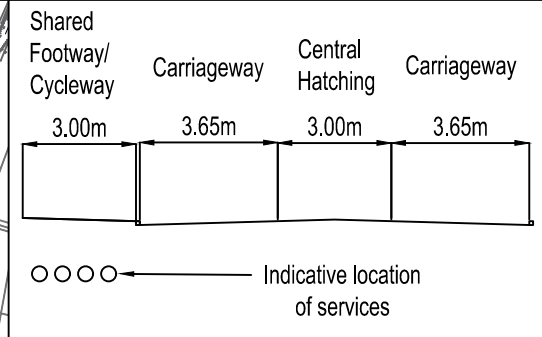
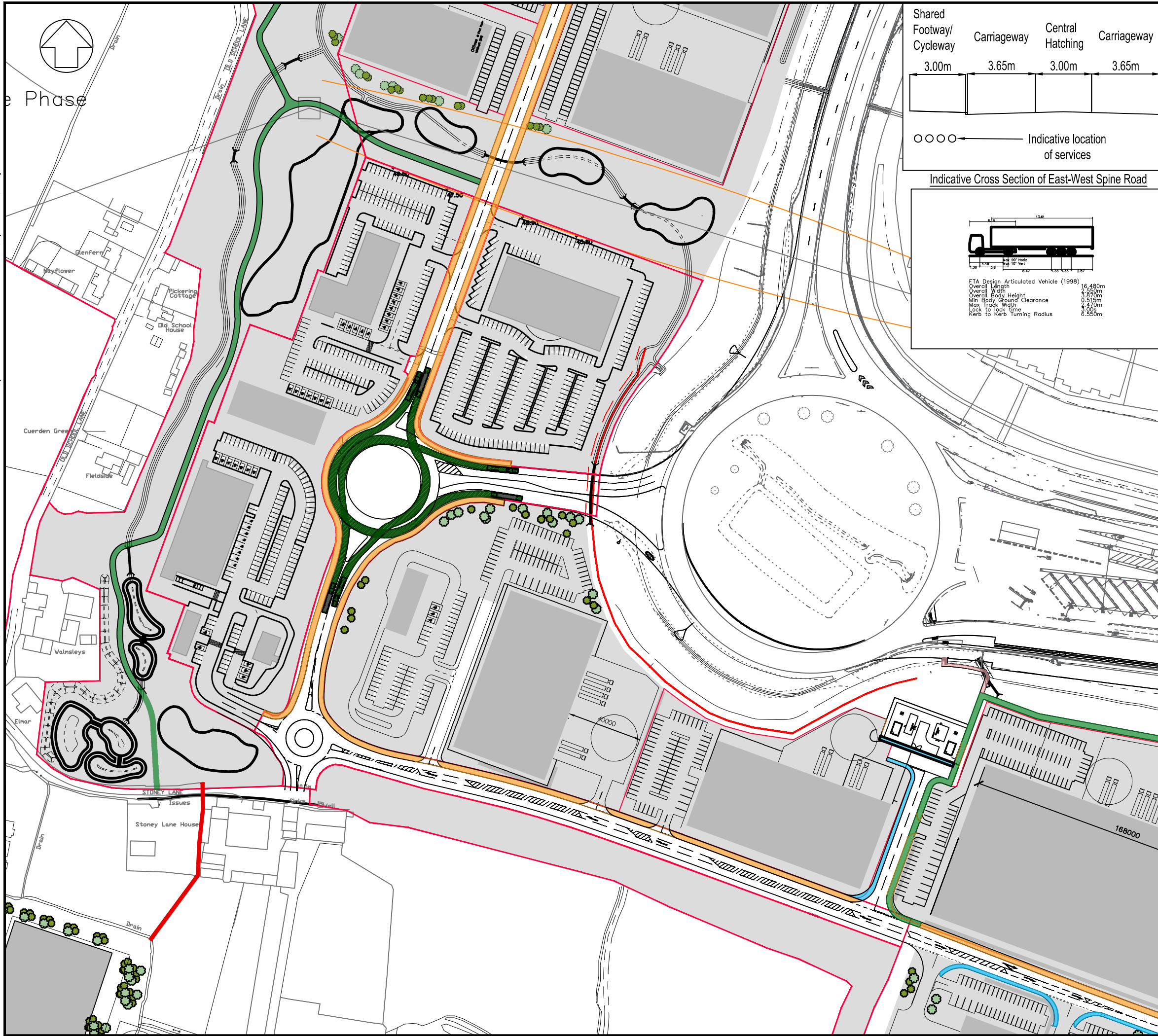

DO NOT SCALE

NOTES

- Route between M65 terminus and Wigan Road (via Phase A and B) to be offered for adoption. Route between M65 terminus and Stanifield Lane (via Phase A, Future Phase and Phase D) to be offered for adoption at a future time when future phase of development and through vehicle route is completed

KEY

- 3m Shared Footway/Cycleway
- Public Right of Way
- Proposed Footway
- Existing Footway

REV	DATE	BY	DESCRIPTION	CHK	APP
P03	15/11/2022	DR	EAST WEST SPINE ROAD AMENDED	HP	
P02	11/11/2022	DR	AMENDED TO SUIT LCC PROW	HP	
P01	10/11/2022	DR	FIRST ISSUE	HP	

DRAWING STATUS: S0 - WORK IN PROGRESS

First Street, Manchester, M15 4RP, UK
T+ 44 (0) 161 200 5000
wsp.com

CLIENT: MAPLE GROVE DEVELOPMENTS

ARCHITECT: FLETCHER RAE

PROJECT: LANCASHIRE CENTRAL, CUERDEN

TITLE: HIGHWAYS LAYOUT SHEET 1 OF 3 INDICATIVE ONLY

SCALE @ A3: 1:2000 CHECKED: APPROVED:

PROJECT No: 70084465 DESIGNED: DRAWN: HJ DATE: December 22

DRAWING No: 84465-WSP-XX-DR-005 REV: P03

© WSP UK Ltd