

This drawing should not be scaled. Dimensions to be verified on site. Any discrepancies should be referred to the Engineer prior to work being put in hand. This drawing is the property of Waterman Infrastructure & Environment Limited, and the drawing is issued on the condition that it is not copied, reproduced, related or disclosed to any unauthorised person, either wholly or in part without the consent in writing of Waterman Infrastructure & Environment Limited. Plotford Wharf, Clink Street, London SE1 9DG. 1 020 7928 7888 1 020 7902 0992

- KEY:**
- DEVELOPMENT BOUNDARY
 - PROPOSED DITCH DIVERSION (DITCH PROFILE 1, DITCH ADJACENT DEVELOPMENT BOUNDARY)
 - PROPOSED DITCH DIVERSION (DITCH PROFILE 2, DITCH THROUGH DEVELOPMENT)
 - PROPOSED CULVERT, DASHED LINE DENOTES EXTENT OF 3m NO BUILD EASEMENT EITHER SIDE OF CULVERT
 - PROPOSED ATTENUATION POND (SERVING PLOT(S)) DASHED LINE DENOTES 5m NO BUILD EASEMENT AROUND POND
 - PROPOSED ATTENUATION POND (SERVING PLOT(S)) DASHED LINE DENOTES 5m NO BUILD EASEMENT AROUND POND
 - ▨ PROPOSED BELOW GROUND ATTENUATION FEATURE (TANKS OR SIMILAR)
 - PROPOSED FOUL WATER PIPES & MANHOLES (ALL FOUL PIPE IN RES' ZONE 150mmØ, ALL REMAINING FOUL PIPES 225Ø)
 - PROPOSED SURFACE WATER PIPES AND MANHOLES SERVING THE ONSITE ADOPTABLE HIGHWAY
 - PROPOSED SURFACE WATER PIPES AND MANHOLES SERVING THE INDIVIDUAL PLOTS / UNITS
 - PROPOSED FLOW ATTENUATION CHAMBER
 - PROPOSED PUMPING STATION & OUTGOING RISING MAIN
 - EXISTING DITCH TO BE DIVERTED
 - EXISTING CULVERT
 - EXISTING DITCH
 - EXISTING SURVEYED DRAINAGE
 - EXISTING HV CABLE

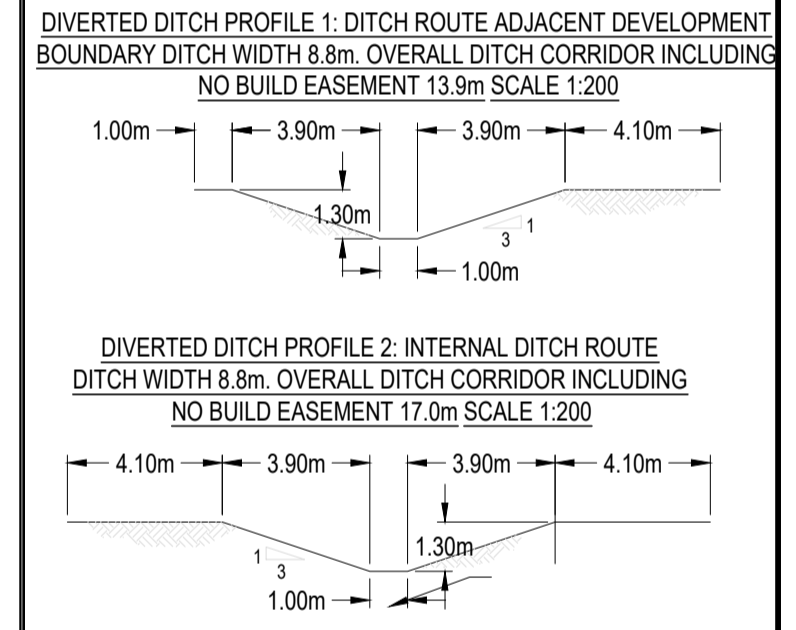

Rev	Date	Description	By
P01	10/06/22	Masterplan and Landscape plan updated	FB
P05	31/05/22	Minor updates	FB
P04	15/05/22	Masterplan updated	FB
P03	17/02/22	Attenuation footprints updated	FB
P02	16/12/21	Drainage details added	FB
P01	04/11/21	Draft Issue for comment	FB

Amendments	
Project	LANCASHIRE CENTRAL, PRESTON
Title	PROPOSED DRAINAGE CONSTRAINTS PLAN SHEET 3
Client	MAPLE GROVE DEVELOPMENTS & LCC

Waterman

2nd Floor South Central 11 Peter Street Manchester M2 5GR
 T: 0161 639 8362 F: 0333 444 501
 mail@watermangroup.com www.watermangroup.com

Drawing Status		
Designed by	Checked by	Project No
Drawn by	Date	11556
Scales @ A1	work to figured dimensions only	Computer File No
1:1000		WE17032

WIE	DR	92	0501-03	P06
-----	----	----	---------	-----

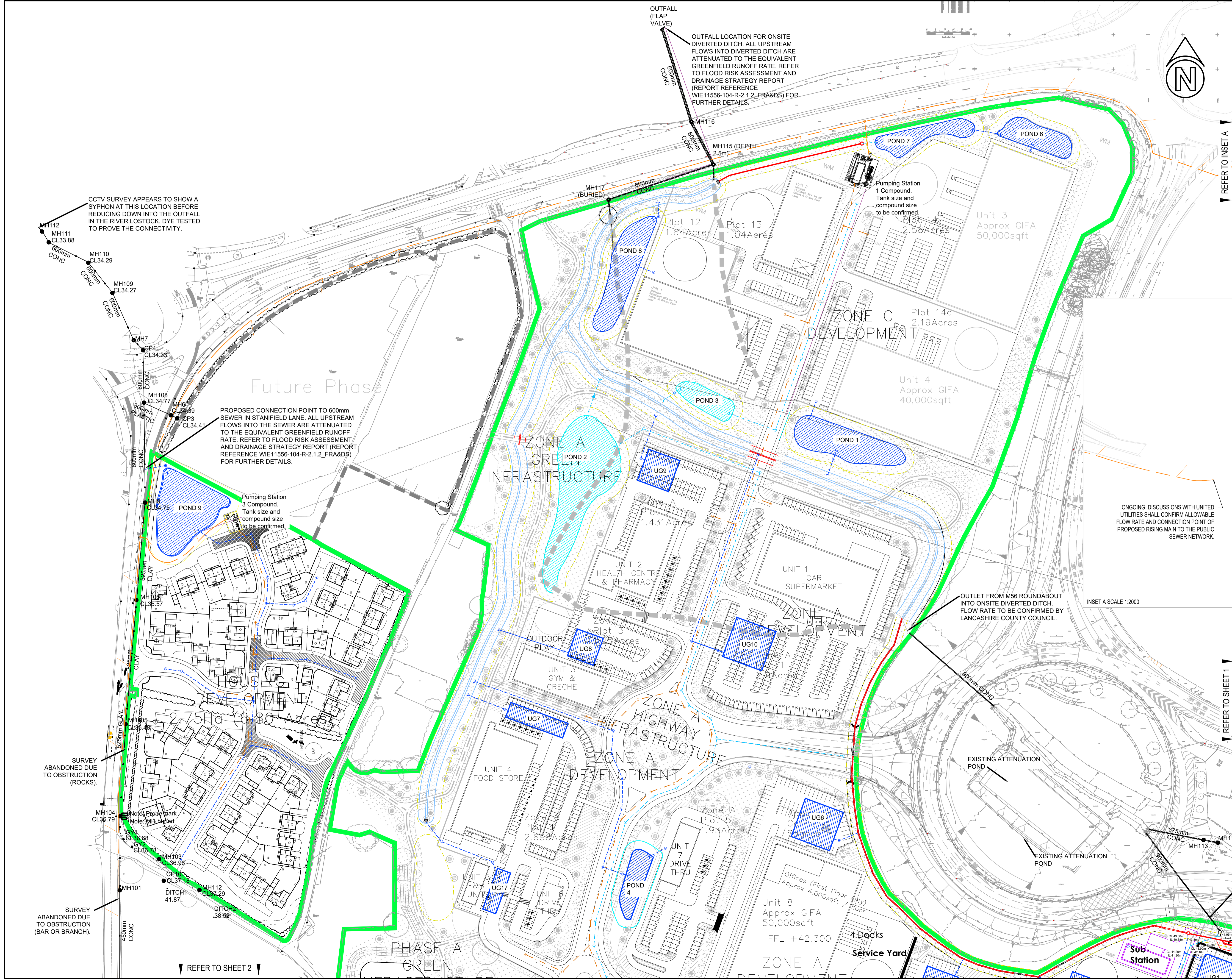

REFER TO INSET A

REFER TO SHEET 1

REFER TO SHEET 2

CCTV SURVEY APPEARS TO SHOW A SYPHON AT THIS LOCATION BEFORE REDUCING DOWN INTO THE SEWER IN THE RIVER LOSTOCK. DYE TESTED TO PROVE THE CONNECTIVITY.

OUTFALL LOCATION FOR ONSITE DIVERTED DITCH. ALL UPSTREAM FLOWS INTO DIVERTED DITCH ARE ATTENUATED TO THE EQUIVALENT GREENFIELD RUNOFF RATE. REFER TO FLOOD RISK ASSESSMENT AND DRAINAGE STRATEGY REPORT (REPORT REFERENCE WIE11556-104-R-2.1.2_FRA&DS) FOR FURTHER DETAILS.

PROPOSED CONNECTION POINT TO 600mm SEWER IN STANFIELD LANE. ALL UPSTREAM FLOWS INTO THE SEWER ARE ATTENUATED TO THE EQUIVALENT GREENFIELD RUNOFF RATE. REFER TO FLOOD RISK ASSESSMENT AND DRAINAGE STRATEGY REPORT (REPORT REFERENCE WIE11556-104-R-2.1.2_FRA&DS) FOR FURTHER DETAILS.

OUTLET FROM M56 ROUNDABOUT INTO ONSITE DIVERTED DITCH. FLOW RATE TO BE CONFIRMED BY LANCASHIRE COUNTY COUNCIL.

ONGOING DISCUSSIONS WITH UNITED UTILITIES SHALL CONFIRM ALLOWABLE FLOW RATE AND CONNECTION POINT OF PROPOSED RISING MAIN TO THE PUBLIC SEWER NETWORK.

SURVEY ABANDONED DUE TO OBSTRUCTION (ROCKS).

SURVEY ABANDONED DUE TO OBSTRUCTION (BAR OR BRANCH).