

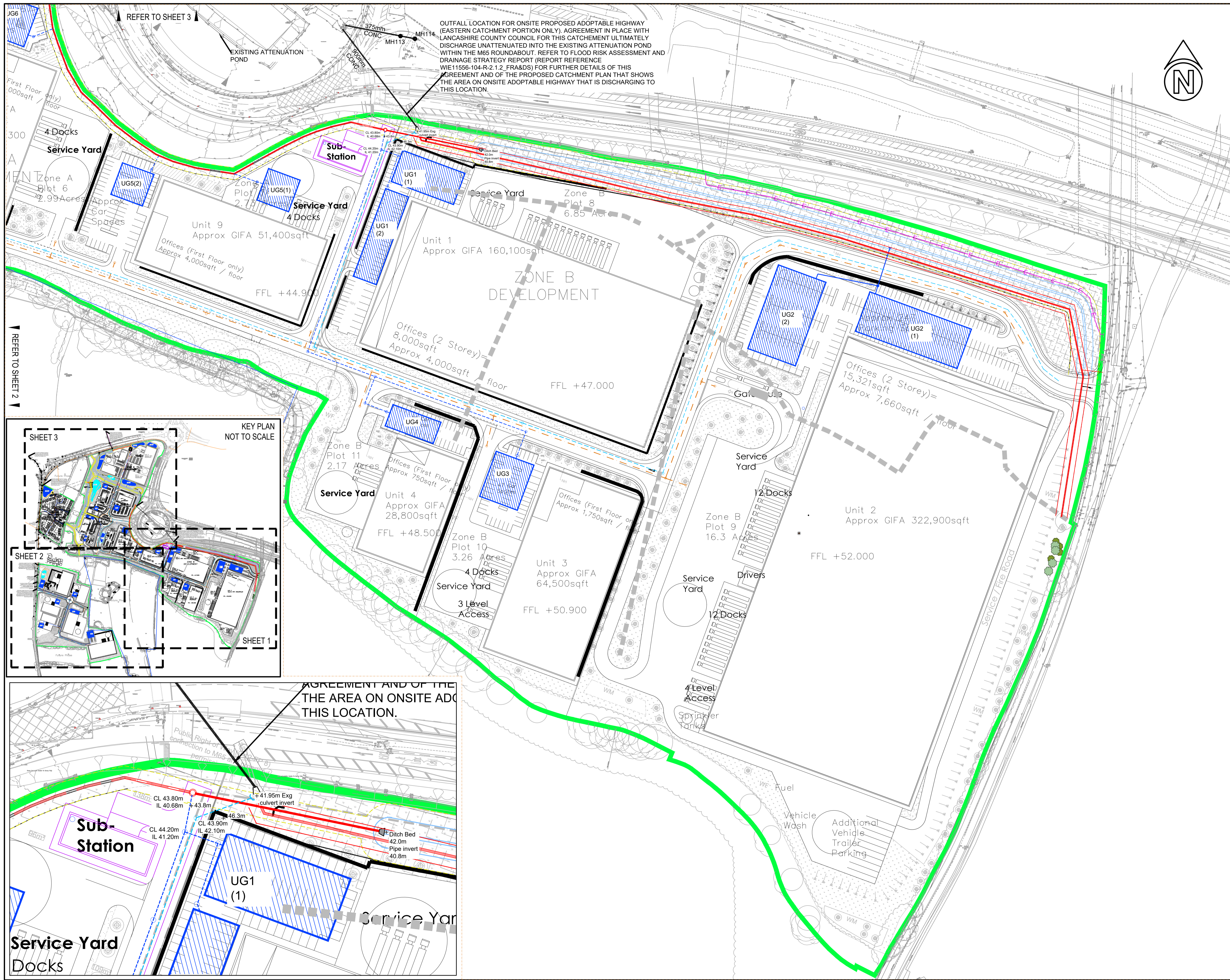

Below Ground Attenuation



OUTFALL LOCATION FOR ONSITE PROPOSED ADOPTABLE HIGHWAY (EASTERN CATCHMENT PORTION ONLY). AGREEMENT IN PLACE WITH LANCASHIRE COUNTY COUNCIL FOR THIS CATCHMENT ULTIMATELY DISCHARGE UNATTENUATED INTO THE EXISTING ATTENUATION POND WITHIN THE M65 ROUNDABOUT. REFER TO FLOOD RISK ASSESSMENT AND DRAINAGE STRATEGY REPORT (REPORT REFERENCE WIE11556-104-R-2.1.2. FRA&DS) FOR FURTHER DETAILS OF THIS AGREEMENT AND OF THE PROPOSED CATCHMENT PLAN THAT SHOWS THE AREA ON ONSITE ADOPTABLE HIGHWAY THAT IS DISCHARGING TO THIS LOCATION.

This drawing should not be scaled. Dimensions to be verified on site. Any discrepancies should be referred to the Engineer prior to work being put in hand.
 This drawing is the property of Waterman Infrastructure & Environment Limited, and the drawing is issued on the condition that it is not copied, reproduced, related or disclosed to any unauthorised person, either wholly or in part without the consent in writing of Waterman Infrastructure & Environment Limited.
 Plotford Wharf, Clink Street, London SE1 9DU. 1 020 7928 7888 1 020 7902 0992

- KEY:**
- DEVELOPMENT BOUNDARY
 - PROPOSED DITCH DIVERSION (DITCH PROFILE 1, DITCH ADJACENT DEVELOPMENT BOUNDARY)
 - PROPOSED DITCH DIVERSION (DITCH PROFILE 2, DITCH THROUGH DEVELOPMENT)
 - PROPOSED CULVERT, DASHED LINE DENOTES EXTENT OF 3m NO BUILD EASEMENT EITHER SIDE OF CULVERT
 - PROPOSED ATTENUATION POND (SERVING HIGHWAY) DASHED LINE DENOTES 5m NO BUILD EASEMENT AROUND POND
 - PROPOSED ATTENUATION POND (SERVING PLOT(S)) DASHED LINE DENOTES 5m NO BUILD EASEMENT AROUND POND
 - ▨ PROPOSED BELOW GROUND ATTENUATION FEATURE (TANKS OR SIMILAR)
 - PROPOSED FOUL WATER PIPES & MANHOLES (ALL FOUL PIPE IN RES' ZONE 150mmØ, ALL REMAINING FOUL PIPES 225Ø)
 - PROPOSED SURFACE WATER PIPES AND MANHOLES SERVING THE ONSITE ADOPTABLE HIGHWAY
 - PROPOSED SURFACE WATER PIPES AND MANHOLES SERVING THE INDIVIDUAL PLOTS / UNITS
 - PROPOSED FLOW ATTENUATION CHAMBER
 - PROPOSED PUMPING STATION & OUTGOING RISING MAIN
 - EXISTING DITCH TO BE DIVERTED
 - EXISTING CULVERT
 - EXISTING DITCH
 - EXISTING SURVEYED DRAINAGE
 - EXISTING HV CABLE

DIVERTED DITCH PROFILE 1: DITCH ROUTE ADJACENT DEVELOPMENT BOUNDARY DITCH WIDTH 8.8m. OVERALL DITCH CORRIDOR INCLUDING NO BUILD EASEMENT 13.9m SCALE 1:200

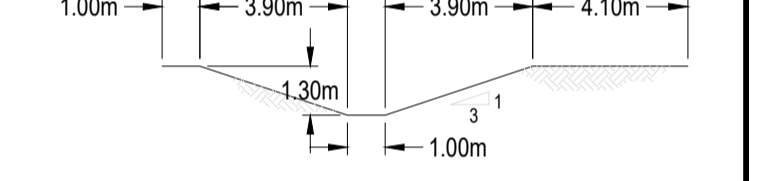

DIVERTED DITCH PROFILE 2: INTERNAL DITCH ROUTE DITCH WIDTH 8.8m. OVERALL DITCH CORRIDOR INCLUDING NO BUILD EASEMENT 17.0m SCALE 1:200

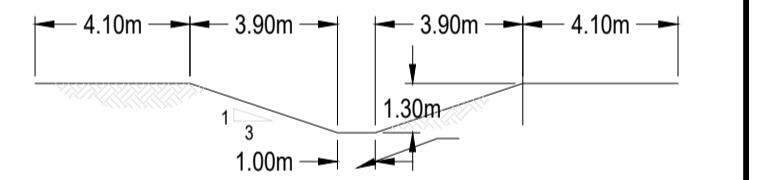

Rev	Date	Description	By
P06	30/05/22	Masterplan and Landscape plan updated	PB
P05	31/05/22	Minor updates	PB
P04	13/05/22	Masterplan updated	PB
P03	18/02/22	Attenuation footprints updated	PB
P02	16/12/21	Drainage details added	PB
P01	04/11/21	Drift Issue for comment	PB

Project
LANCASHIRE CENTRAL, PRESTON

Title
PROPOSED DRAINAGE CONSTRAINTS PLAN SHEET 1

Client
MAPLE GROVE DEVELOPMENTS & LCC



2nd Floor South Central 11 Peter Street Manchester M2 5QR
 T: 0161 639 8362 F: 0333 444 501
 mail@watermangroup.com www.watermangroup.com

Drawing Status
PLANNING

Designed by	PB	Checked by		Project No	11556
Drawn by	PB	Date	29 OCT 21	Computer File No	WIE17032
Scales @ A1		work to figured dimensions only 1:1000			

WIE DR 92 0501-01 P06

