

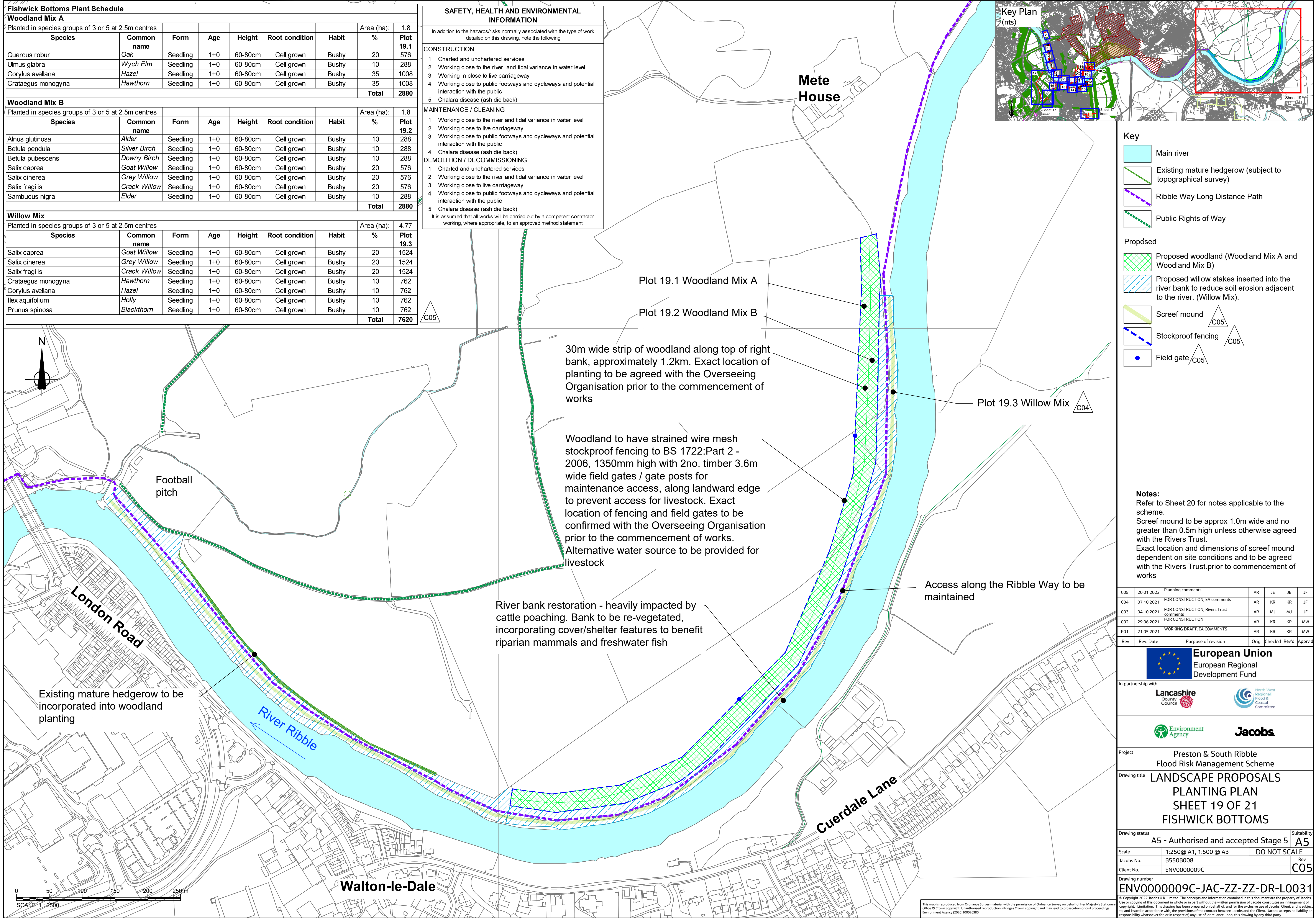





Fishwick Bottoms Plant Schedule								
Woodland Mix A								
Planted in species groups of 3 or 5 at 2.5m centres							Area (ha):	1.8
Species	Common name	Form	Age	Height	Root condition	Habit	%	Plot 19.1
Quercus robur	Oak	Seedling	1+0	60-80cm	Cell grown	Bushy	20	576
Ulmus glabra	Wych Elm	Seedling	1+0	60-80cm	Cell grown	Bushy	10	288
Corylus avellana	Hazel	Seedling	1+0	60-80cm	Cell grown	Bushy	35	1008
Crataegus monogyna	Hawthorn	Seedling	1+0	60-80cm	Cell grown	Bushy	35	1008
							Total	2880
Woodland Mix B								
Planted in species groups of 3 or 5 at 2.5m centres							Area (ha):	1.8
Species	Common name	Form	Age	Height	Root condition	Habit	%	Plot 19.2
Alnus glutinosa	Alder	Seedling	1+0	60-80cm	Cell grown	Bushy	10	288
Betula pendula	Silver Birch	Seedling	1+0	60-80cm	Cell grown	Bushy	10	288
Betula pubescens	Downy Birch	Seedling	1+0	60-80cm	Cell grown	Bushy	10	288
Salix caprea	Goat Willow	Seedling	1+0	60-80cm	Cell grown	Bushy	20	576
Salix cinerea	Grey Willow	Seedling	1+0	60-80cm	Cell grown	Bushy	20	576
Salix fragilis	Crack Willow	Seedling	1+0	60-80cm	Cell grown	Bushy	20	576
Sambucus nigra	Elder	Seedling	1+0	60-80cm	Cell grown	Bushy	10	288
							Total	2880
Willow Mix								
Planted in species groups of 3 or 5 at 2.5m centres							Area (ha):	4.77
Species	Common name	Form	Age	Height	Root condition	Habit	%	Plot 19.3
Salix caprea	Goat Willow	Seedling	1+0	60-80cm	Cell grown	Bushy	20	1524
Salix cinerea	Grey Willow	Seedling	1+0	60-80cm	Cell grown	Bushy	20	1524
Salix fragilis	Crack Willow	Seedling	1+0	60-80cm	Cell grown	Bushy	20	1524
Crataegus monogyna	Hawthorn	Seedling	1+0	60-80cm	Cell grown	Bushy	10	762
Corylus avellana	Hazel	Seedling	1+0	60-80cm	Cell grown	Bushy	10	762
Ilex aquifolium	Holly	Seedling	1+0	60-80cm	Cell grown	Bushy	10	762
Prunus spinosa	Blackthorn	Seedling	1+0	60-80cm	Cell grown	Bushy	10	762
							Total	7620

SAFETY, HEALTH AND ENVIRONMENTAL INFORMATION	
<p>In addition to the hazards/risks normally associated with the type of work detailed on this drawing, note the following</p>	
CONSTRUCTION	
<ul style="list-style-type: none">1 Charted and uncharted services2 Working close to the river, and tidal variance in water level3 Working in close to live carriageway4 Working close to public footways and cycleways and potential interaction with the public5 Chlalaria disease (ash die back)	
MAINTENANCE / CLEANING	
<ul style="list-style-type: none">1 Working close to the river and tidal variance in water level2 Working close to live carriageway3 Working close to public footways and cycleways and potential interaction with the public4 Chlalaria disease (ash die back)	
DEMOLITION / DECOMMISSIONING	
<ul style="list-style-type: none">1 Charted and uncharted services2 Working close to the river and tidal variance in water level3 Working close to live carriageway4 Working close to public footways and cycleways and potential interaction with the public5 Chlalaria disease (ash die back)	
<p>It is assumed that all works will be carried out by a competent contractor working, where appropriate, to an approved method statement</p>	



C05	20.01.2022	Planning comments	AR	JE	JE	JF
C04	07.10.2021	FOR CONSTRUCTION, EA comments	AR	KR	KR	JF
C03	04.10.2021	FOR CONSTRUCTION, Rivers Trust comments	AR	MJ	MJ	JF
C02	29.06.2021	FOR CONSTRUCTION	AR	KR	KR	MW
P01	21.05.2021	WORKING DRAFT, EA COMMENTS	AR	KR	KR	MW
Rev	Rev. Date	Purpose of revision	Orig	Check'd	Rev'd	Apprv'd

 <div> <h1>European Union</h1> <h2>European Regional Development Fund</h2> </div>			
In partnership with <div>   </div>			
			
Project Preston & South Ribble Food Risk Management Scheme			
Drawing title LANDSCAPE PROPOSALS PLANTING PLAN SHEET 19 OF 21 FISHWICK BOTTOMS			
Drawing status A5 - Authorised and accepted Stage 5			Suitability A5
Scale	1:250 @ A1, 1:500 @ A3		DO NOT SCALE
Jacobs No.	B5500808		Rev
Client No.	ENV0000009C		C05
Drawing number ENV0000009C-JAC-ZZ-ZZ-DR-L0031			
<small> © Copyright 2022 Jacobs U.K. Limited. The concepts and information contained in this document are the property of Jacobs. Use or copying of this document in whole or in part without the written permission of Jacobs constitutes an infringement of copyright. Limitation: This drawing has been prepared on behalf of, and for the exclusive use of Jacobs' Client, and is subject to and issued in accordance with, the provisions of the contract between Jacobs and the Client. Jacobs accepts no liability or responsibility whatsoever for, or in respect of, any use of, or reliance upon, this drawing by any third party. </small>			