

Ornamental shrub planting									Area: 95m²
Species	Form	Pot vol	Height	Type	Habit	No. of breaks	Density (no./m²)	Plot	16.1
Cornus sanguinea 'Midwinter Fire'	Shrub	3L	30-40cm	CG	Bushy	3	3	15	
Euonymus fortunei 'Emerald Gaeity'	Shrub	3L	20-30cm	CG	Bushy	3	4	16	
Hypericum moserianum	Shrub	3L	20-30cm	CG	Bushy	3	4	27	
Lavandula angustifolia 'Munstead'	Shrub	2L	20-30cm	CG	Bushy	3	5	15	
Mahonia aquifolium 'Apollo'	Shrub	3L	20-30cm	CG	Bushy	3	3	15	
Olearia x haastii	Shrub	3L	30-40cm	CG	Bushy	3	3	90	
Photinia x fraseri 'Little Red Robin'	Shrub	3L	20-30cm	CG	Bushy	3		15	
Potentilla davurica 'Abbotswood'	Shrub	3L	20-30cm	CG	Bushy	3	3	36	
Potentilla 'Tangerine'	Shrub	3L	20-30cm	CG	Bushy	3		9	
Spiraea japonica 'Darts Red'	Shrub	2L	20-30cm	CG	Bushy	3	3	10	
Perennials and grasses								Total	248
Species	Form	Pot vol	Height	Type	Habit	No. of buds	Density (no./m²)	Plot	16.1
Bergenia 'Bressingham Ruby'	Perennial	2L	20-30cm	CG	-	4	5	47	
Bergenia 'Silberlicht'	Perennial	2L	20-30cm	CG	-	4	5	32	
Stachys byzantina	Perennial	2L	20-30cm	CG	-	4	6	12	
								Total	91

Amenity grassland (grass seed mix for general areas and making good)		
Mix: EG22 - Strong lawn grass mixture		
Supplier: Emorsgate Seeds, www.wildseed.co.uk or similar approved		
Sowing Rate: 25g/m²		
%	Species	Common name
5	Agrostis capillaris	Common Bent
50	Festuca rubra	Slender-creeping Red-fescue
25	Lolium perenne	Perennial Ryegrass
20	Poa pratensis	Smooth-stalked Meadow-grass

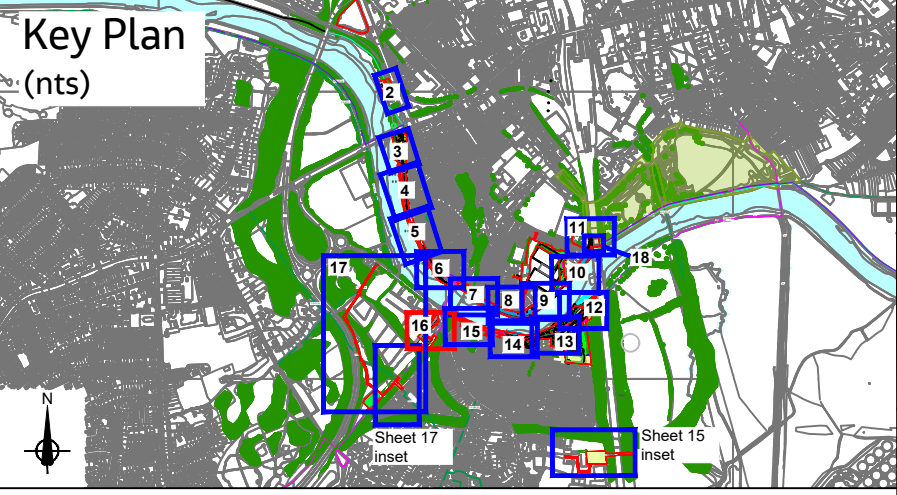
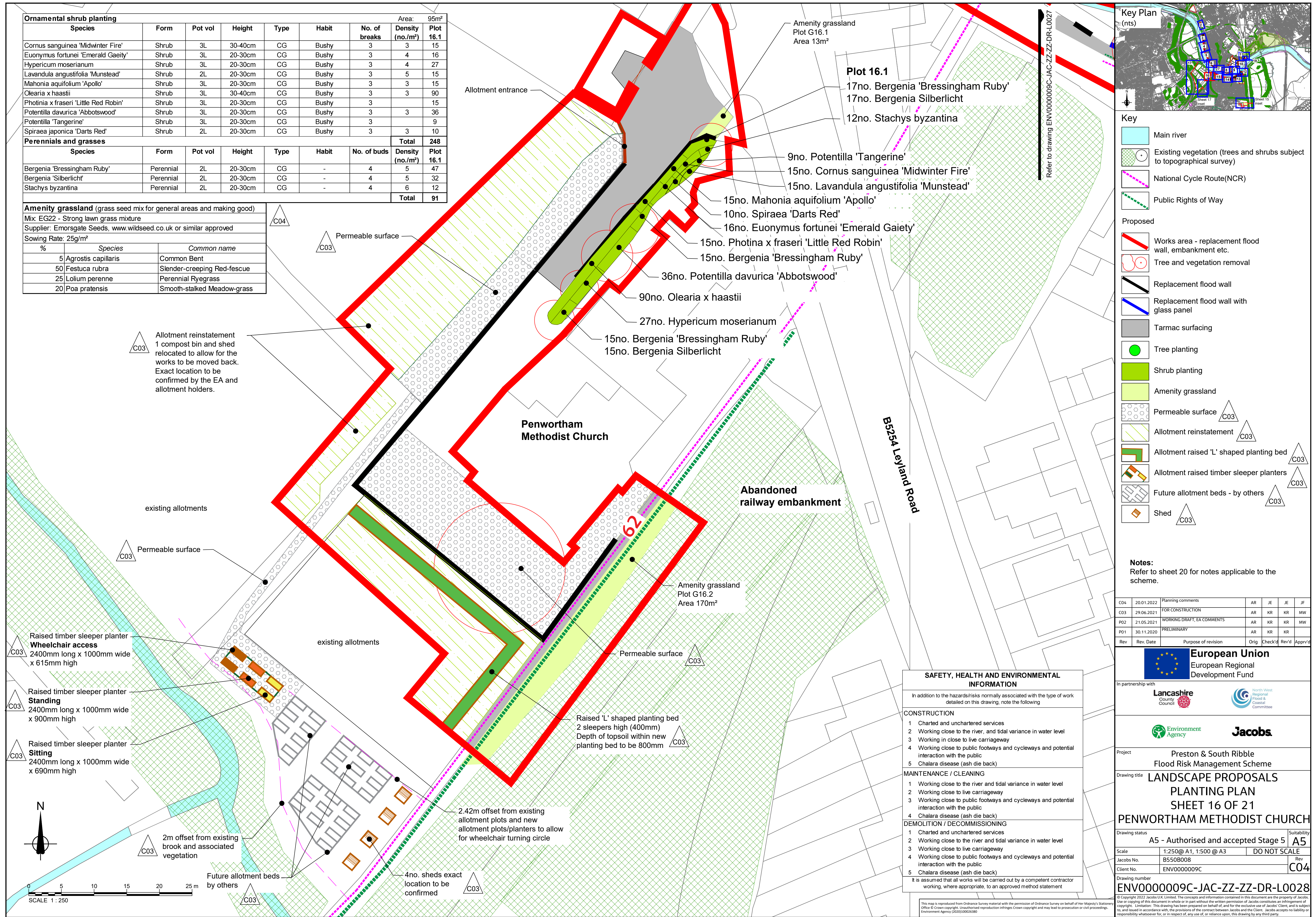

Key	
	Main river
	Existing vegetation (trees and shrubs subject to topographical survey)
	National Cycle Route(NCR)
	Public Rights of Way

Proposed	
	Works area - replacement flood wall, embankment etc.
	Tree and vegetation removal
	Replacement flood wall
	Replacement flood wall with glass panel
	Tarmac surfacing
	Tree planting
	Shrub planting
	Amenity grassland
	Permeable surface
	Allotment reinstatement
	Allotment raised 'L' shaped planting bed
	Allotment raised timber sleeper planters
	Future allotment beds - by others
	Shed

Notes:
Refer to sheet 20 for notes applicable to the scheme.

C04	20.01.2022	Planning comments	AR	JE	JE	JF
C03	29.06.2021	FOR CONSTRUCTION	AR	KR	KR	MW
P02	21.05.2021	WORKING DRAFT, EA COMMENTS	AR	KR	KR	MW
P01	30.11.2020	PRELIMINARY	AR	KR	KR	
Rev	Rev. Date	Purpose of revision	Orig	Check'd	Rev'd	Apprv'd



Project: Preston & South Ribble Flood Risk Management Scheme
Drawing title: LANDSCAPE PROPOSALS PLANTING PLAN SHEET 16 OF 21
PENWORTHAM METHODIST CHURCH

Drawing status: A5 - Authorised and accepted Stage 5
Scale: 1:250@ A1, 1:500 @ A3 DO NOT SCALE
Jacobs No. B550B008
Client No. ENV0000009C

Drawing number: ENV0000009C-JAC-ZZ-ZZ-DR-L0028

SAFETY, HEALTH AND ENVIRONMENTAL INFORMATION	
In addition to the hazards/risks normally associated with the type of work detailed on this drawing, note the following	
CONSTRUCTION	
1 Chartered and unchartered services	
2 Working close to the river, and tidal variance in water level	
3 Working in close to live carriageway	
4 Working close to public footways and cycleways and potential interaction with the public	
5 Chalara disease (ash die back)	
MAINTENANCE / CLEANING	
1 Working close to the river and tidal variance in water level	
2 Working close to live carriageway	
3 Working close to public footways and cycleways and potential interaction with the public	
4 Chalara disease (ash die back)	
DEMOLITION / DECOMMISSIONING	
1 Chartered and unchartered services	
2 Working close to the river and tidal variance in water level	
3 Working close to live carriageway	
4 Working close to public footways and cycleways and potential interaction with the public	
5 Chalara disease (ash die back)	
It is assumed that all works will be carried out by a competent contractor working, where appropriate, to an approved method statement	

This map is reproduced from Ordnance Survey material with the permission of Ordnance Survey on behalf of Her Majesty's Stationery Office © Crown copyright. Unauthorised reproduction infringes Crown copyright and may lead to prosecution or civil proceedings. Environment Agency (2020)100026380