

1 Plan 1
SCALE 1:200

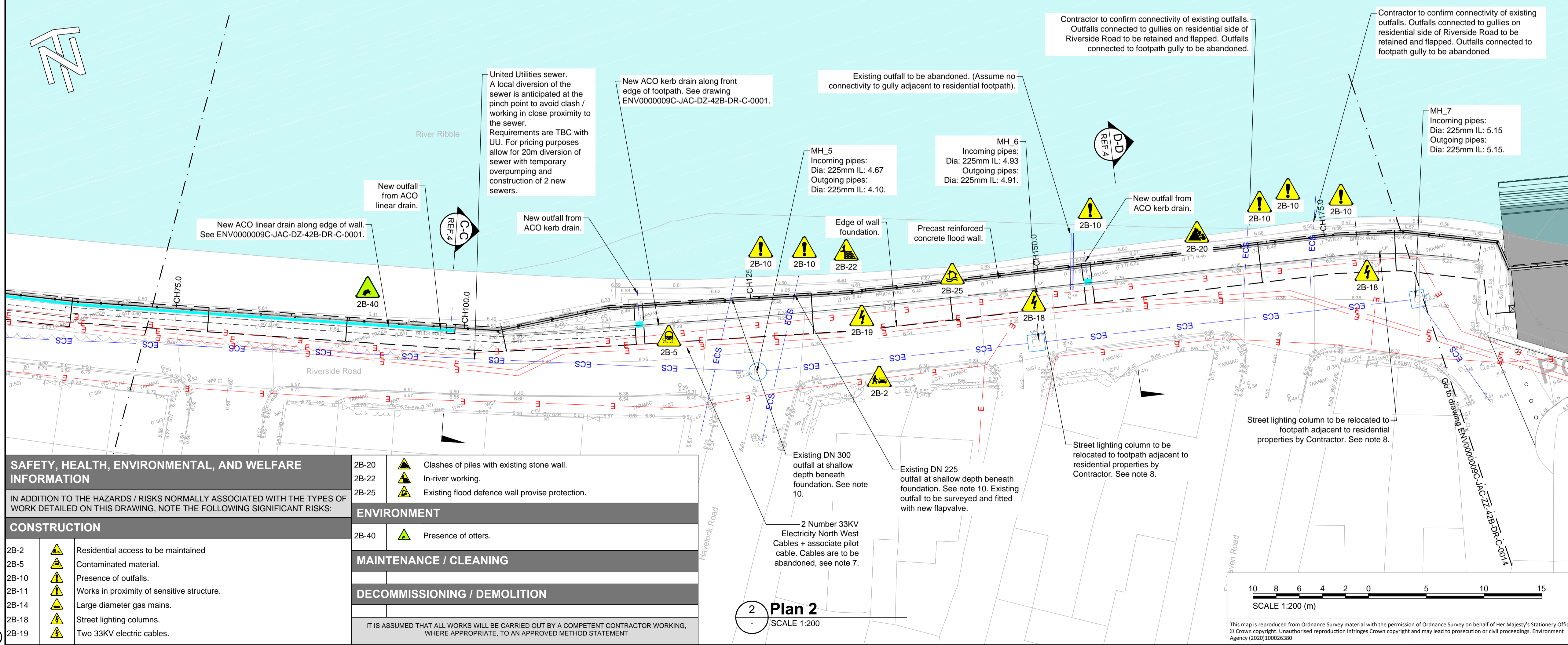

2 Plan 2
SCALE 1:200

SAFETY, HEALTH, ENVIRONMENTAL, AND WELFARE INFORMATION	
2B-20	Clashes of piles with existing stone wall.
2B-22	In-river working.
2B-25	Existing flood defence wall provide protection.
ENVIRONMENT	
2B-40	Presence of otters.
MAINTENANCE / CLEANING	
DECOMMISSIONING / DEMOLITION	
IT IS ASSUMED THAT ALL WORKS WILL BE CARRIED OUT BY A COMPETENT CONTRACTOR WORKING, WHERE APPROPRIATE, TO AN APPROVED METHOD STATEMENT	

CONSTRUCTION	
2B-2	Residential access to be maintained
2B-5	Contaminated material.
2B-10	Presence of outfalls.
2B-11	Works in proximity of sensitive structure.
2B-14	Large diameter gas mains.
2B-18	Street lighting columns.
2B-19	Two 33KV electric cables.

- REFERENCES**
- ENV000009C-JAC-ZZ-42B-DR-C-0014 AREA 2B PROPOSED SERVICE DIVERSION AND MODIFICATION WORKS SHEET 2 OF 2.
 - ENV000009C-JAC-ZZ-42B-DR-C-0005 AREA 2B EXISTING FEATURES AND HAZARDS SHEET 1 OF 4.
 - ENV000009C-JAC-ZZ-42B-DR-C-0001 AREA 2B GENERAL ARRANGEMENT PLAN 1 OF 3.
 - ENV000009C-JAC-DZ-42B-DR-C-0001 AREA 2B SECTIONS AND DETAILS SHEET 1 OF 4.
 - ENV000009C-JAC-ZZ-42B-DR-C-0009 AREA 2B DEMOLITION AND SITE CLEARANCE PLAN SHEET 1 OF 4.
 - ENV000009C-JAC-DW-42B-DR-S-0001 AREA 2B CONCRETE GA PLAN SHEET 1 OF 2.

- LEGEND**
- E ELECTRICITY CABLES
 - ECS COMBINED SEWER
 - LP STREET LIGHTING COLUMNS
 - EG CADENT GAS PIPES
 - RIVER
 - WALL
 - FOUNDATION
 - ACO LINEAR DRAIN
 - ACO OUTFALL

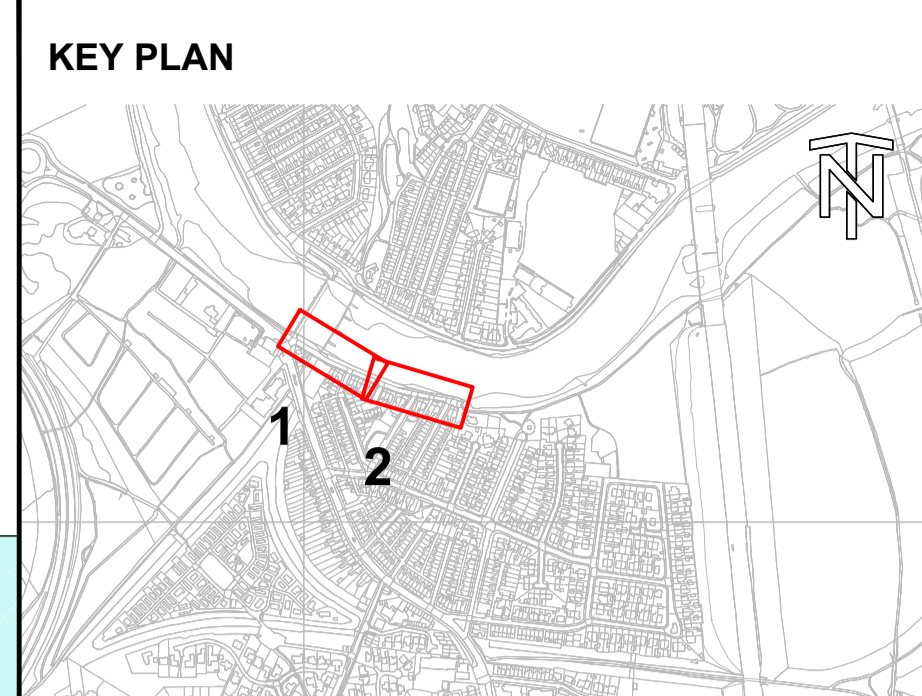

- GENERAL NOTES**
- ALL DIMENSIONS ARE IN MILLIMETRES UNLESS STATED OTHERWISE.
 - ALL LEVELS ARE IN METRES ABOVE ORDNANCE DATUM.
 - EXISTING VIRGIN MEDIA, LOW VOLTAGE ELECTRIC CABLES, UNITED UTILITIES WATER SUPPLY PIPES, BT CABLES, LOW PRESSURE GAS ETC ARE PRESENT IN THE RESIDENTIAL FOOTPATH ADJACENT TO THE PROPERTIES ALONG RIVERSIDE ROAD. FOR LOCATION OF THESE AND ALL OTHER EXISTING SERVICES REFER TO THE STATS PLANS OBTAINED FROM STATUTORY UNDERTAKERS LOCATED IN THE PRE-CONSTRUCTION INFORMATION DOCUMENT.
 - CADENT GAS ASSETS. WORKING METHODOLOGY IS TO BE CARRIED OUT IN ACCORDANCE WITH CADENT GAS SAFE WORKING PRACTICES. REFER TO THE WORKS INFORMATION FOR FULL REQUIREMENTS.
 - THE CONTRACTOR IS RESPONSIBLE FOR ENSURING THAT THE INTEGRITY OF THE SEWER IS MAINTAINED THROUGHOUT THE CONSTRUCTION PROGRAMME. WORKING METHODOLOGY IS TO BE IN ACCORDANCE TO UNITED UTILITIES REQUIREMENTS. PRE AND POST CONSTRUCTION CCTV SURVEYS ARE REQUIRED TO ESTABLISH AND VERIFY THE CONDITION OF THE SEWER. REFER TO THE WORKS INFORMATION FOR FULL REQUIREMENTS.
 - TRIAL HOLES ARE REQUIRED TO CONFIRM THE EXTENT OF CSO CHAMBER AND ENSURE NO CLASHES OCCUR WITH WALL ALIGNMENT.
 - 33KV ELECTRICITY NORTH WEST ELECTRIC CABLES. CABLES ARE TO BE DIVERTED BY ELECTRICITY NORTH WEST. REFER TO WORKS INFORMATION FOR CONFIRMATION OF FULL REQUIREMENTS AND TIMING CONSTRAINTS. CONTRACTOR TO BE RESPONSIBLE FOR ARRANGING WITH ELECTRICITY NORTH WEST TO ATTEND SITE AND VERIFY THAT EXISTING CABLES ARE DEAD (SPIKED OR SIMILAR). THE CONTRACTOR WILL BE RESPONSIBLE FOR REMOVING ALL REDUNDANT CABLES WHICH IMPINGE UPON THE EXCAVATION.
 - STREET LIGHTING COLUMNS ARE TO BE DIVERTED BY CONTRACTOR DURING THE WORKS. THE ASSOCIATED SUPPLY CABLE IS TO ALSO BE DISCONNECTED AND REMOVED BY THE CONTRACTOR. DISCONNECTION REQUIREMENTS ARE TO BE AGREED WITH ELECTRICITY NORTH WEST. LOCATION OF NEW STREET LIGHTING COLUMNS IS ASSUMED TO BE IN THE FOOTPATH ADJACENT TO RESIDENTIAL PROPERTIES. THE EXACT LOCATION IS TO BE AGREED WITH LANCSHIRE COUNTY COUNCIL STREET LIGHTING TEAM. REFER TO THE WORKS INFORMATION FOR FULL REQUIREMENTS AND TIMING CONSTRAINTS.
 - ALL OUTFALLS ARE TO BE POSITIVELY IDENTIFIED IN LOCATION. REFER TO LONG SECTION DRAWINGS ENV000009C-JAC-DZ-42B-DR-C-0005 AND ENV000009C-JAC-DZ-42B-DR-C-0006 FOR LEVEL INFORMATION. A CLEAR DISTANCE IS REQUIRED OF 1M TO OUTFALL LOCATIONS FROM ANY CFA PILES AND LOCAL ADJUSTMENT IN PILE CENTRES BY THE CONTRACTOR IS REQUIRED TO SUIT.
 - THE CONTRACTOR SHALL POSITIVELY LOCATE THE LOCATION OF ALL EXISTING SERVICES WITH ELECTRONIC SCANNING AND TRIAL HOLES PRIOR TO CONSTRUCTION COMMENCING.

Rev	Rev. Date	Purpose of revision	Orig	Check'd	Rev'd	Apprv'd
C02	2021-06-25	For Construction	JS	NP	SM	MW
P01	2020-10-16	Full Business Case	JS	CF	NP	MW

European Union
European Regional
Development Fund

In partnership with
Lancashire
County Council

North West
Regional
Flood &
Coastal
Committee

Environment
Agency

Jacobs

Project
**Preston & South Ribble
Flood Risk Management Scheme**

Drawing title
**Area 2B
Proposed Service Diversion
and Modification Works
Sheet 1 of 2**

Drawing status
A5 - Authorised and accepted Stage 5

Scale
1:200 @ A1

Jacobs No.
B550B008

Client No.
ENV000009C

Drawing number
ENV000009C-JAC-ZZ-42B-DR-C-0013

Suitability
A5

Rev
C02

DO NOT SCALE

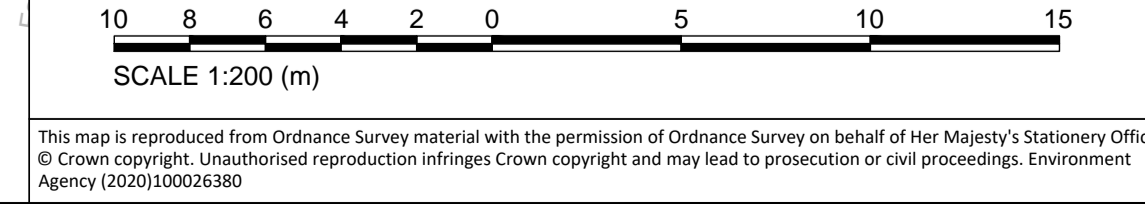

This map is reproduced from Ordnance Survey material with the permission of Ordnance Survey on behalf of Her Majesty's Stationery Office © Crown copyright. Unauthorised reproduction infringes Crown copyright and may lead to prosecution or civil proceedings. Environment Agency (2020)100026380

C:\pwworkdir\weerevagency\egint\lornalm\dmso7415\ENV000009C-JAC-ZZ-42B-DR-C-0013.dwg - 6/24/2021 8:31:08 AM - A1Frame - FORNALM