

- Notes:**
- Inset 1 and 3 Garden Reinstatement**
 - Raised rectangular planting bed: 2 timber sleeper high, layout as shown on inset 1. Pressure treated softwood sleepers laid on a concrete foundation 150mm deep by 350 wide. Concrete 1:2.5:3.5 parts cement:sand:gravel. Cut sleepers to length and cut the ends to overlap the corners. Sleepers secured together using countersunk TimberLok heavy duty wood screws or similar approved. All surrounding surfaces to be made good.
 - Existing grass disturbed to allow for the works to be reinstated and turfed in accordance with the landscape specification.
 - Existing paving to be reinstated as per inset 1 and within inset 3 area as required and the landscape specification.
 - Existing fencing and gutters to be reinstated to match existing
 - All surrounding surfaces to be made good.
 - Inset 2 Ribble Cottage**
 - Planting to be on road side of the boundary fencing.
 - Temporary vehicular and pedestrian gates:** Exact location of temporary timber vehicular and pedestrian gates and gate posts to be confirmed. The contractor is to allow for making good of existing fence panels to accommodate gates. And for the removal of the timber gates and reinstatement of fencing to match existing once the gates are no longer required.
 - Cricket scoreboard:** To be securely fixed to club house building in accordance with the manufacturers recommendations. Existing scoreboard to be removed from site and the grass area made good.
 - SHE Box:** Refer to sheet 9.

Reinstate fence to match existing

Garden to be reinstated refer to inset 1 for details

Plot 10.6 Privet Hedge
20no. Ligustrum vulgare

Removal and replacement of hedge along no. 22

Replacement garden fencing/walls to no. 20 and 22 South End to match existing

Garden to be reinstated, including gutter to new extension to match existing. Refer to inset 3 for planting

New fence to match existing

SCALE 1:500

INSET 1 - Garden Reinstatement, Plot 10.4
Scale 1:100

Paving area to be reinstated with Marshalls Saxon buff paving 600x600x50mm edged with Saxon edging (916x150x50mm)

5no. Euonymus fortunei 'Silver Queen'

3no. Cornus sanguinea 'Midwinter Fire'

3no. Potentilla davurica 'Abbotswood'

5no. Sedum spectabile 'Brilliant'

3no. Bergenia 'Bressingham Ruby'

5no. Festuca amethystina

3no. Verbena bonariensis

Raised planting bed, rectangular, 2 sleepers high (400mm). Supply and lay topsoil to make up level of planting bed prior to planting

3no. Philadelphus 'Belle Etoile'

3no. Spiraea japonica 'Darts Red'

4no. Crocosmia x crocosmiiflora

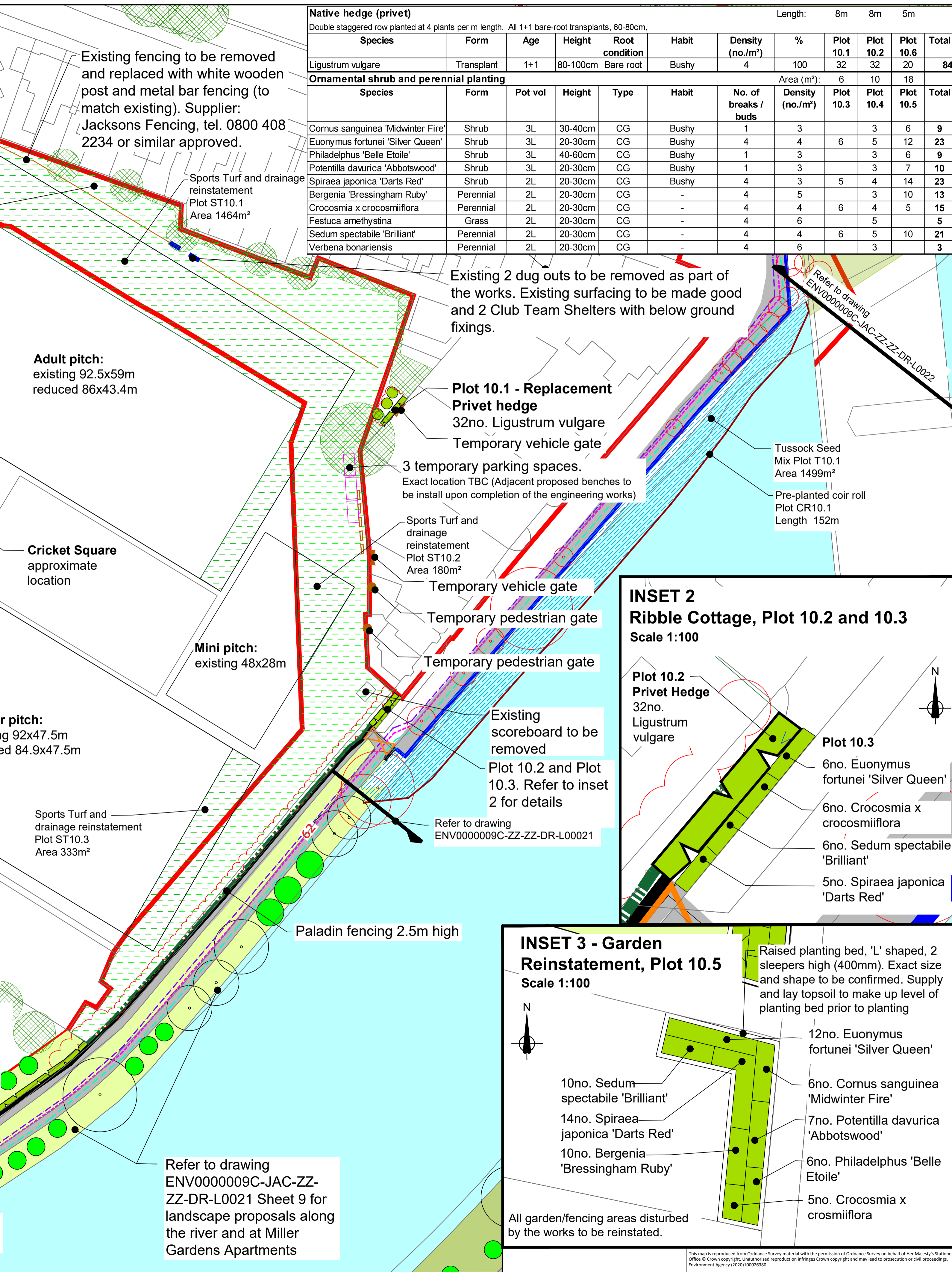

Native hedge (privet)
Double staggered row planted at 4 plants per m length. All 1+1 bare-root transplants, 60-80cm.

Species	Form	Age	Height	Root condition	Habit	Density (no./m ²)	%	Plot 10.1	Plot 10.2	Plot 10.6	Total
Ligustrum vulgare	Transplant	1+1	80-100cm	Bare root	Bushy	4	100	32	32	20	84

Ornamental shrub and perennial planting

Species	Form	Pot vol	Height	Type	Habit	No. of breaks / buds	Density (no./m ²)	Plot 10.3	Plot 10.4	Plot 10.5	Total
Cornus sanguinea 'Midwinter Fire'	Shrub	3L	30-40cm	CG	Bushy	1	3		3	6	9
Euonymus fortunei 'Silver Queen'	Shrub	3L	20-30cm	CG	Bushy	4	4	6	5	12	23
Philadelphus 'Belle Etoile'	Shrub	3L	40-60cm	CG	Bushy	1	3		3	6	9
Potentilla davurica 'Abbotswood'	Shrub	3L	20-30cm	CG	Bushy	1	3		3	7	10
Spiraea japonica 'Darts Red'	Shrub	2L	20-30cm	CG	Bushy	4	3	5	4	14	23
Bergenia 'Bressingham Ruby'	Perennial	2L	20-30cm	CG	-	4	5		3	10	13
Crocosmia x crocosmiiflora	Perennial	2L	20-30cm	CG	-	4	4	6	4	5	15
Festuca amethystina	Grass	2L	20-30cm	CG	-	4	6		5	5	5
Sedum spectabile 'Brilliant'	Perennial	2L	20-30cm	CG	-	4	4	6	5	10	21
Verbena bonariensis	Perennial	2L	20-30cm	CG	-	4	6		3	3	3

INSET 2 Ribble Cottage, Plot 10.2 and 10.3
Scale 1:100

Plot 10.2 Privet Hedge 32no. Ligustrum vulgare

Plot 10.3 6no. Euonymus fortunei 'Silver Queen'

6no. Crocosmia x crocosmiiflora

6no. Sedum spectabile 'Brilliant'

5no. Spiraea japonica 'Darts Red'

INSET 3 - Garden Reinstatement, Plot 10.5
Scale 1:100

Raised planting bed, 'L' shaped, 2 sleepers high (400mm). Exact size and shape to be confirmed. Supply and lay topsoil to make up level of planting bed prior to planting

12no. Euonymus fortunei 'Silver Queen'

6no. Cornus sanguinea 'Midwinter Fire'

7no. Potentilla davurica 'Abbotswood'

6no. Philadelphus 'Belle Etoile'

5no. Crocosmia x crocosmiiflora

10no. Sedum spectabile 'Brilliant'

14no. Spiraea japonica 'Darts Red'

10no. Bergenia 'Bressingham Ruby'

All garden/fencing areas disturbed by the works to be reinstated.

Key Plan (nts)

Key

- Main river
- Amenity grassland
- Existing vegetation (trees and shrubs subject to topographical survey)
- Preston Guild Wheel (walking and cycle route)
- Ribble Way Long Distance Path
- National Cycle Route

Proposed

- Works area - replacement flood wall, embankment etc.
- Tree/vegetation removal
- Replacement flood wall
- Redi-Rock
- White wooden post and metal bar fencing (950mm high). Jackson's Fencing (tel 0800 480 2234) or similar approved
- Bench - Forest Saver recycled plastic seat. Earth Anchors (tel. 020 86849001) or similar approved
- Club Team Shelter 2.5m long
- Stadia Sports (tel. 01782 571719) or similar approved
- Cricket scoreboard. Ref. DC22. Durant Cricket (tel. 01572 822013) or similar approved. Securely fixed to building, exact location TBC
- Temporary vehicular gate. Timber twin-leaf gate 1.8m high x 3.1m width overall. STD Rye Gates and posts. Jacksons fine fencing or similar approved
- Temporary pedestrian gate. Timber, 1.8m high and 1.0m wide, Flat Top Featherboard Gate and posts. Jacksons fine fencing or similar approved.
- Timber fence to match existing
- Hedge planting
- Amenity grassland
- Sports turf and drainage reinstatement. LT6 Sports, Lindum Turf Ltd (Tel. 01904 448675) or similar approved.
- Sports grass seed and drainage reinstatement. SOS mix sown at 40g/m². Barenbrug (Tel. 01359 272000) or similar approved.
- Pre-planted coir roll to base of Redi-Rock (Approx. 240m long from the Cadent Gas pipe bridge to Miller Gardens Apartments)
- Raised planting bed, refer to inset 1 and 3

Legend

- Shrub planting
- Tree planting

C03	13.07.2021	FOR CONSTRUCTION	AR	KR	KR	MW
P02	21.05.2021	WORKING DRAFT, EA COMMENTS	AR	KR	KR	MW
P01	30.11.2020	PRELIMINARY	AR	KR	KR	

Rev | Rev. Date | Purpose of revision | Orig | Check'd | Rev'd | Appr'd

European Union
European Regional Development Fund

In partnership with
Lancashire County Council | North West Regional Flood & Coastal Committee

Environment Agency | **Jacobs**

Project: Preston & South Ribble Flood Risk Management Scheme

Drawing title: **LANDSCAPE PROPOSALS PLANTING PLAN SHEET 10 OF 21 - RIVERSIDE**

Drawing status: A5 - Authorised and accepted Stage 5 | Suitability: A5

Scale: 1:500@ A1 | DO NOT SCALE

Jacobs No. B550B008 | Rev: C03

Client No. ENV000009C

Drawing number: **ENV000009C-JAC-ZZ-ZZ-DR-L0022**

© Copyright 2021 Jacobs UK Limited. The concepts and information contained in this document are the property of Jacobs. Use or copying of this document in whole or in part without the written permission of Jacobs constitutes an infringement of copyright. Limitation: This drawing has been prepared on behalf of, and for the exclusive use of, Jacobs' Client, and is subject to, and issued in accordance with, the provisions of the contract between Jacobs and the Client. Jacobs accepts no liability or responsibility whatsoever for, or in respect of, any use of, or reliance upon, this drawing by any third party.