





**Key**

-  Main river
-  Existing mature hedgerow (subject to topographical survey)
-  Ribble Way Long Distance Path
-  Public Rights of Way
-  Proposed woodland

**Notes:**  
Refer to Figure 1.6 (Sheet 2 of 9 - Broadgate)

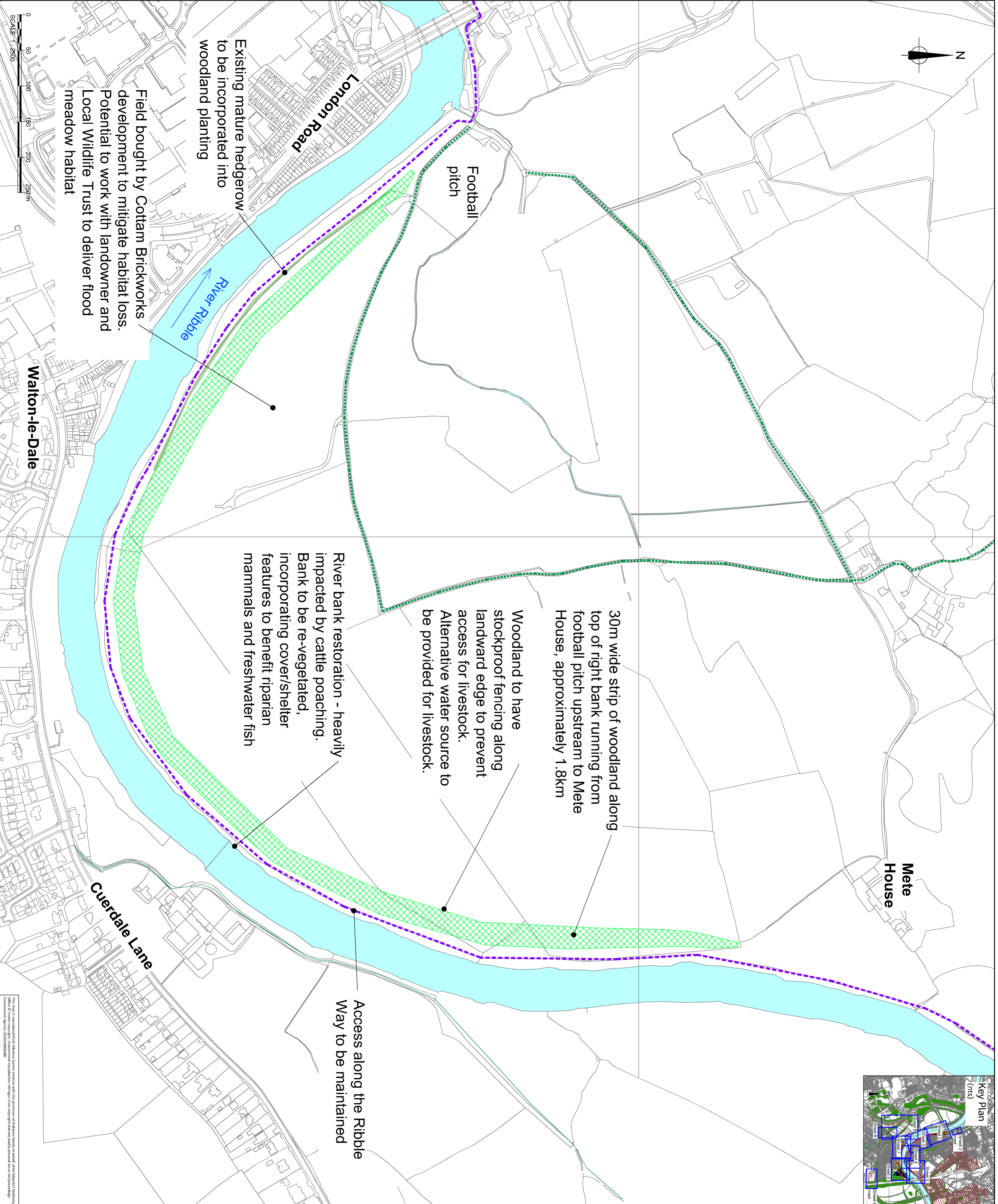

Existing mature hedgerow to be incorporated into woodland planting

Field bought by Cottam Brickworks development to mitigate habitat loss. Potential to work with landowner and Local Wildlife Trust to deliver flood meadow habitat

30m wide strip of woodland along top of right bank running from football pitch upstream to Mete House, approximately 1.8km

Woodland to have stockproof fencing along landward edge to prevent access for livestock. Alternative water source to be provided for livestock.

River bank restoration - heavily impacted by cattle poaching. Bank to be re-vegetated, incorporating cover/shelter features to benefit riparian mammals and freshwater fish

Access along the Ribble Way to be maintained



This map is reproduced from Ordnance Survey material with the permission of Ordnance Survey pursuant to the Ordnance Survey Act of 1947. This information is not intended to constitute a contract. It is provided as a guide only and is not intended to be used for navigation. The Ordnance Survey name is a registered trademark of Ordnance Survey Limited. All other names are the property of their respective owners. © Crown Copyright and the Ordnance Survey. All rights reserved. Ordnance Survey Licence No: 100019990.

<p>Project Preston &amp; South Ribble Flood Risk Management Scheme</p> <p>Drawing title ENVIRONMENTAL MASTERPLAN SHEET 9 OF 9 - FISHWICK BOTTOMS</p> <p>Drawing number ENV0000009C-JAC-ZZ-ZZ-DR-L0010</p>	<p>Drawing status PLANNING</p> <p>Scale 1:2500 @ A1 1:5000 @ A3 DO NOT SCALE</p> <p>Jacobs No. B5508008</p> <p>Client No. PO3</p>	<p>In partnership with Lancashire County Council Environment Agency European Union European Regional Development Fund</p> <p>Jacobs</p>	<table border="1"> <tr> <th>Rev</th> <th>Rev. Date</th> <th>Purpose of revision</th> <th>Orig</th> <th>Checked</th> <th>Rev'd</th> <th>Appr'd</th> </tr> <tr> <td>PO3</td> <td>01.12.2020</td> <td>PLANNING, updated titleblock</td> <td>AB</td> <td>SK</td> <td>SK</td> <td>MW</td> </tr> <tr> <td>PO2</td> <td>10.11.2020</td> <td>PLANNING</td> <td>AB</td> <td>KR</td> <td>KR</td> <td>MW</td> </tr> <tr> <td>PO1</td> <td>21.02.2020</td> <td>PRELIMINARY</td> <td>AB</td> <td>KR</td> <td>KR</td> <td>MW</td> </tr> </table>	Rev	Rev. Date	Purpose of revision	Orig	Checked	Rev'd	Appr'd	PO3	01.12.2020	PLANNING, updated titleblock	AB	SK	SK	MW	PO2	10.11.2020	PLANNING	AB	KR	KR	MW	PO1	21.02.2020	PRELIMINARY	AB	KR	KR	MW
Rev	Rev. Date	Purpose of revision	Orig	Checked	Rev'd	Appr'd																									
PO3	01.12.2020	PLANNING, updated titleblock	AB	SK	SK	MW																									
PO2	10.11.2020	PLANNING	AB	KR	KR	MW																									
PO1	21.02.2020	PRELIMINARY	AB	KR	KR	MW																									