

5 Disused Railway Abutment Plan
SCALE 1:25

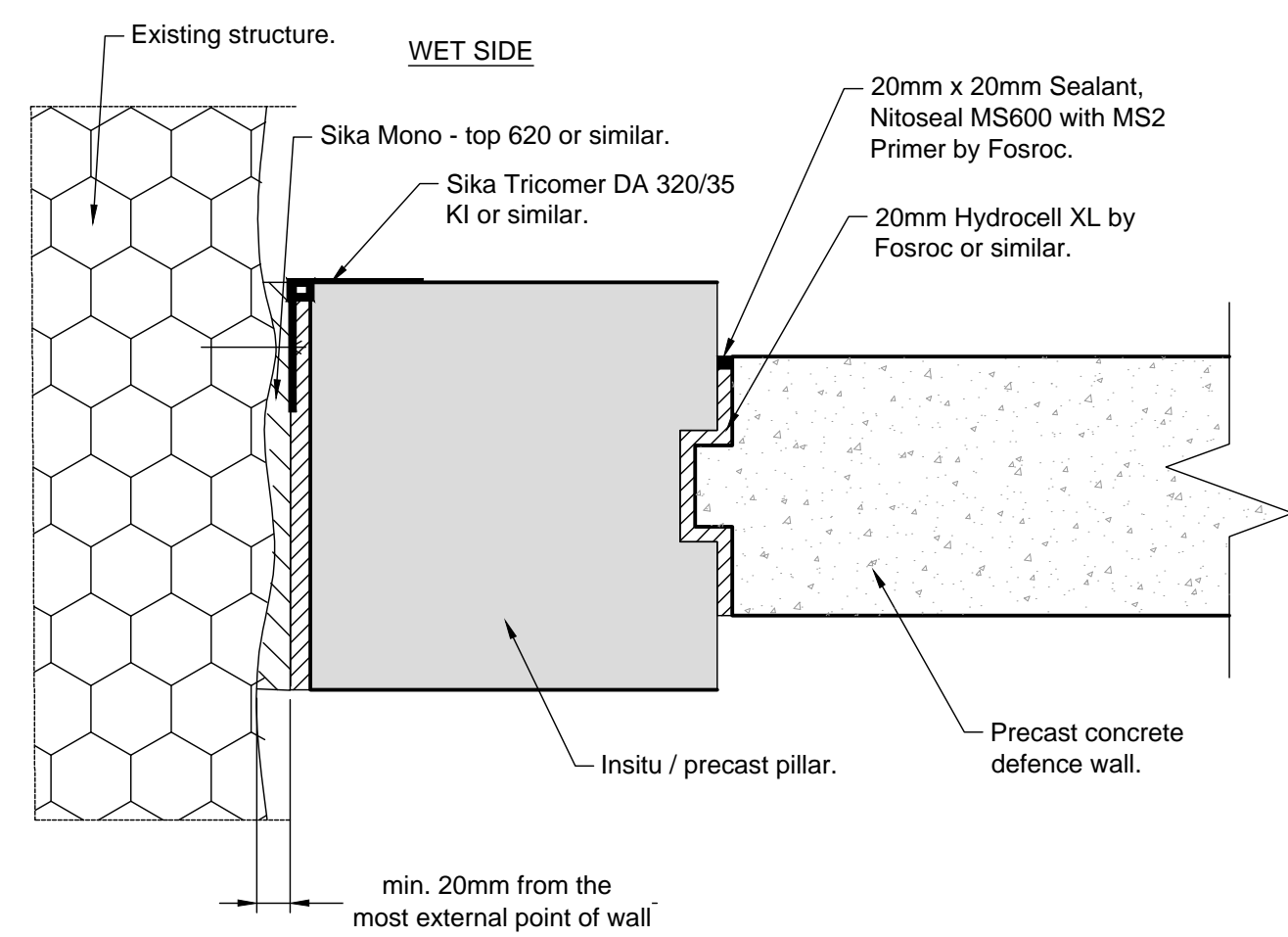

7 Structural Tie-In Detail 1
SCALE 1:10

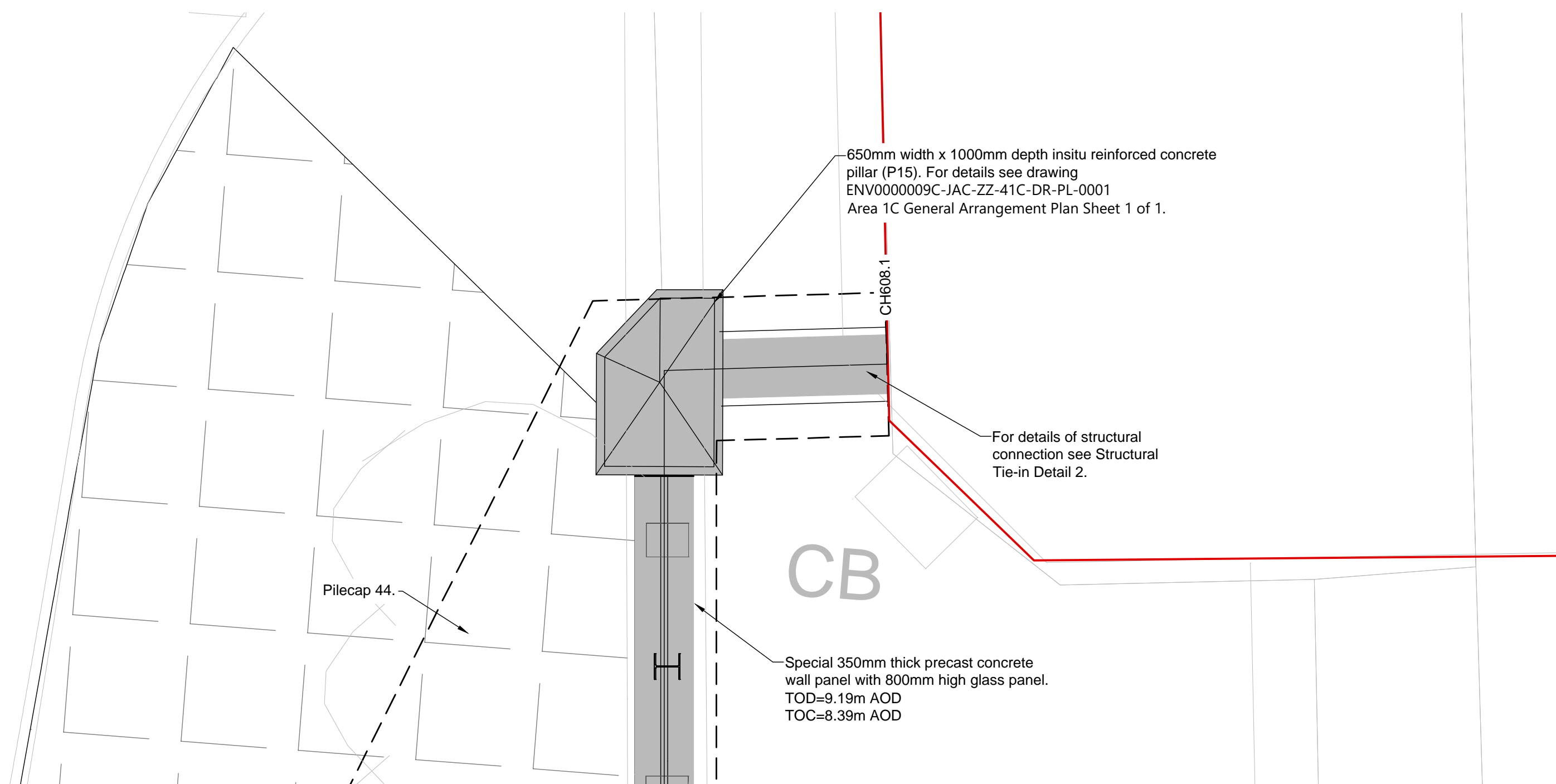
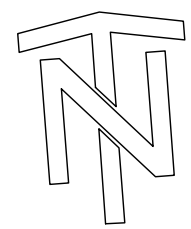

6 West Coast Main Line Railway Abutment Plan
SCALE 1:25

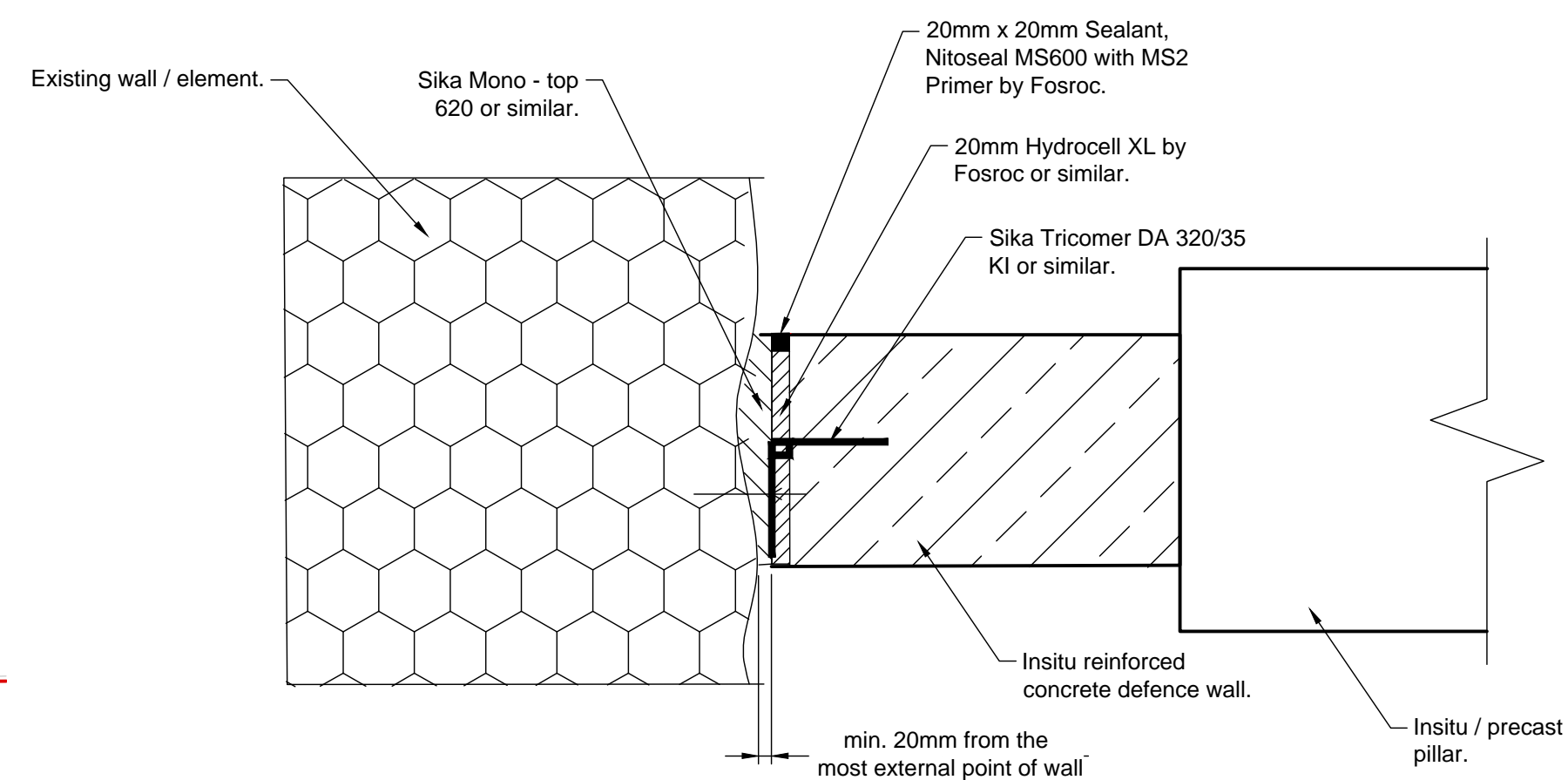

8 Structural Tie-In Detail 2
SCALE 1:10

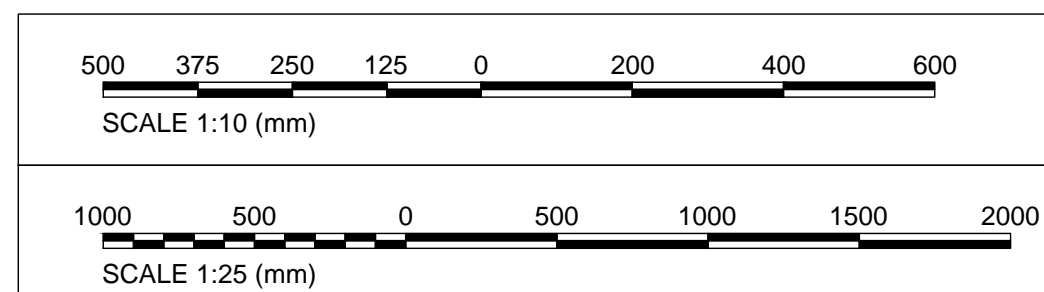

KEY PLAN

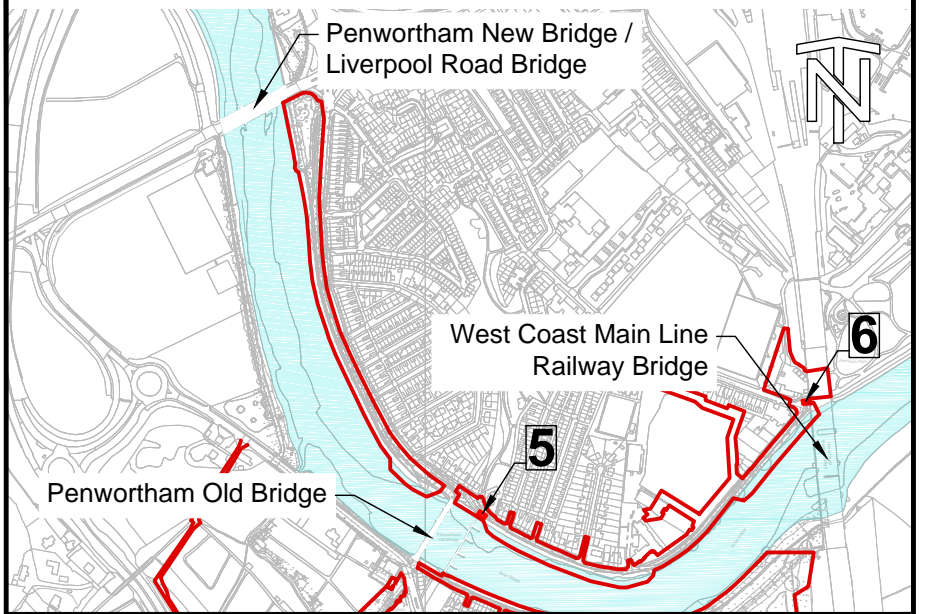

GENERAL NOTES

- ALL DIMENSIONS ARE IN MILLIMETRES UNLESS NOTED OTHERWISE.
- FOR ALL NOTES REFER TO DRG ENV0000009C-JAC-ZZ-41B-DR-PL-0001/0003 AREA 1B GENERAL ARRANGEMENT PLAN SHEET 1/3 OF 3.

REFERENCES

- ENV0000009C-JAC-ZZ-41B-DR-PL-0001/0003 AREA 1B GENERAL ARRANGEMENT PLAN SHEET 1/3 OF 3.

LEGEND

	PRECAST CONCRETE WALL
	EXISTING STRUCTURE
	TARMAC PAVEMENT
	FOUNDATION OUTLINE
	INSITU REINFORCED CONCRETE WALL
	LAND REQUIRED TO UNDERTAKE DEVELOPMENT
	PILLARS
	GLASS PANELS

TOC=TOP OF CONCRETE
TOD=TOP OF DEFENCE
TOF=TOP OF FOUNDATION

P01	2020-11-16	For Planning	MF	APR	NP	MW
Rev	Rev. Date	Purpose of revision	Orig	Check'd	Rev'd	Apprv'd



In partnership with		
---------------------	--	--



Project	Preston & South Ribble Flood Risk Management Scheme
---------	--

Drawing title	Area 1 Tie-in Details Sheet 2 of 3
---------------	--

Drawing status	S4 - Suitable for stage approval	Suitability	S4
Scale	@ A1	DO NOT SCALE	

Jacobs No.	B550B008	Rev	
Client No.	ENV0000009C	Rev	P01

Drawing number	ENV0000009C-JAC-DW-41X-DR-PL-0003
----------------	-----------------------------------

© Copyright 2020 Jacobs U.K. Limited. The concepts and information contained in this document are the property of Jacobs. Use or copying of this document in whole or in part without the written permission of Jacobs constitutes an infringement of copyright. Limitation: This drawing has been prepared on behalf of, and for the exclusive use of Jacobs' Client, and is subject to, and issued in accordance with, the provisions of the contract between Jacobs and the Client. Jacobs accepts no liability or responsibility whatsoever for, or in respect of, any use of, or reliance upon, this drawing by any third party.