

1 Penwortham New Bridge (Liverpool Road Bridge) Plan
SCALE 1:25

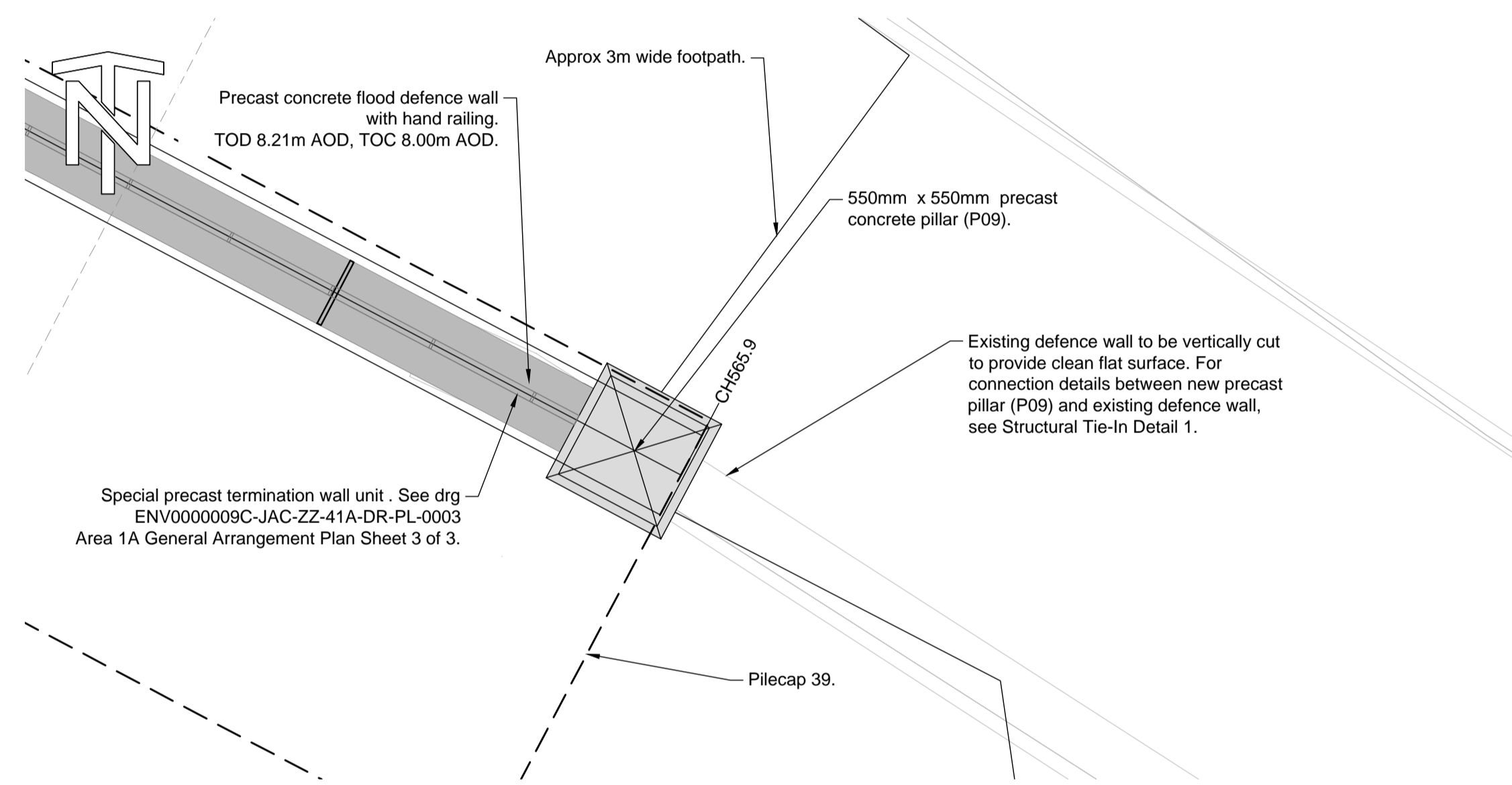

2 Penwortham Old Bridge (Downstream) Plan
SCALE 1:25

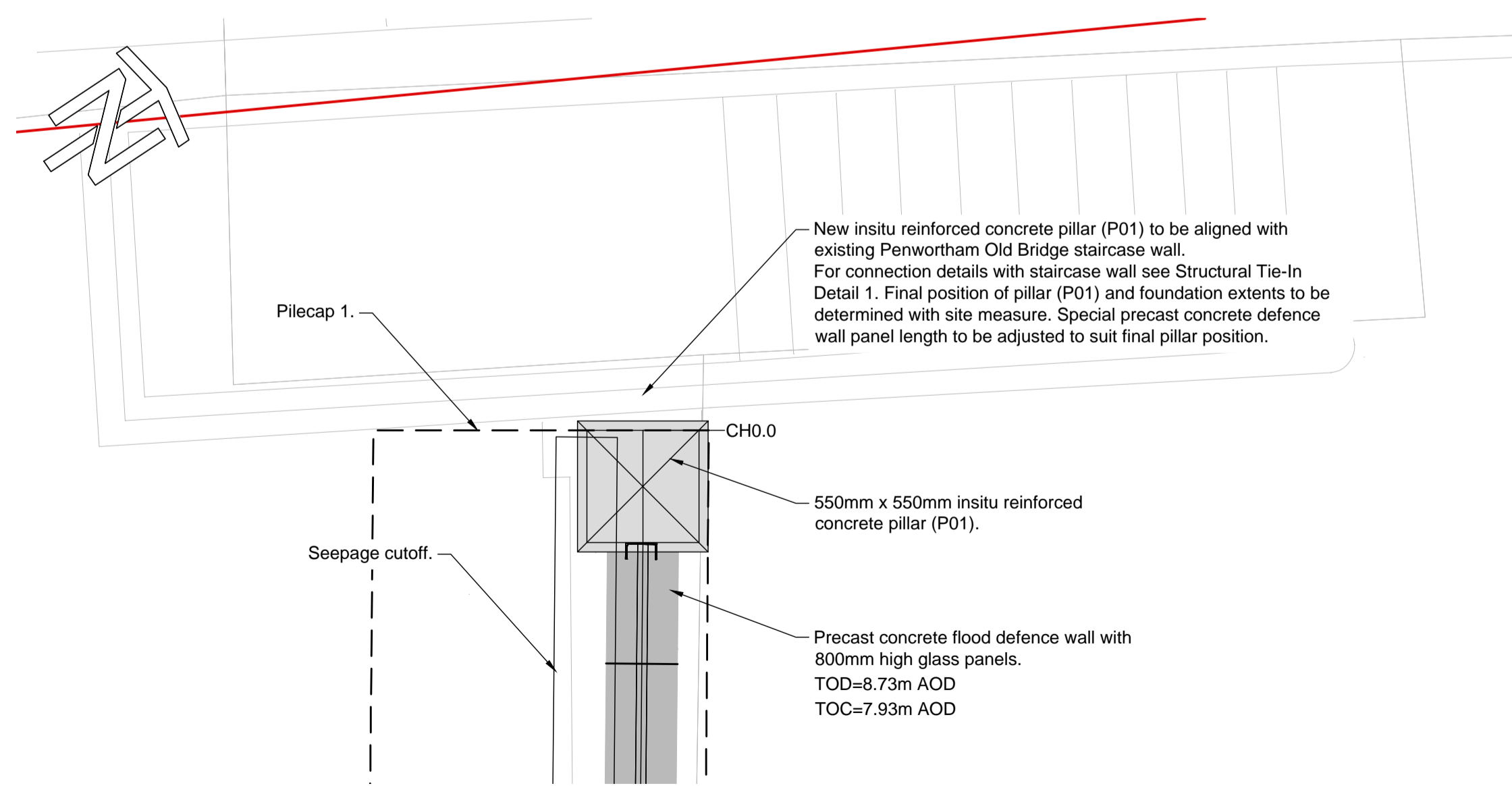

3 Penwortham Old Bridge (Upstream) Plan
SCALE 1:25

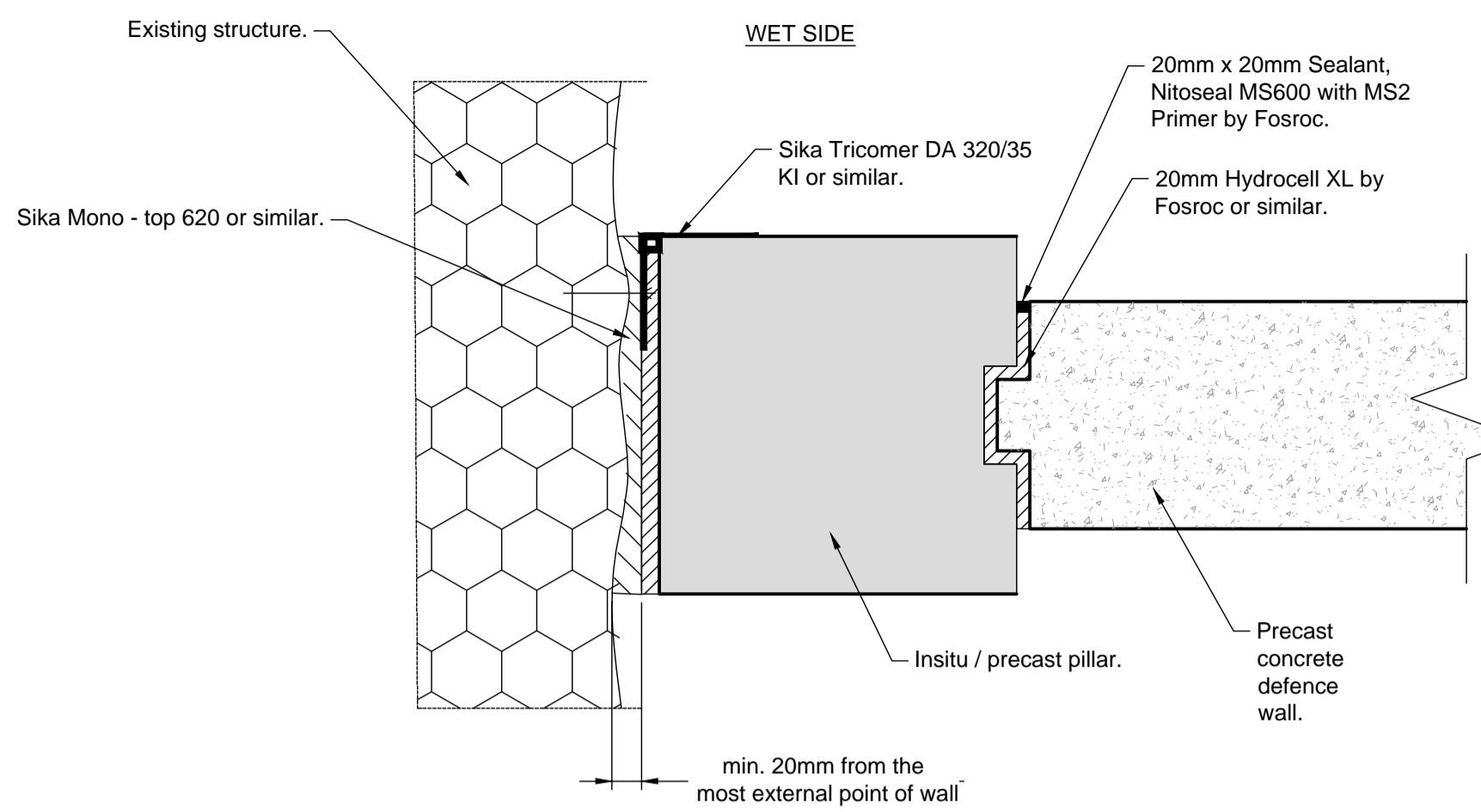

4 Structural Tie-In Detail 1
SCALE 1:10

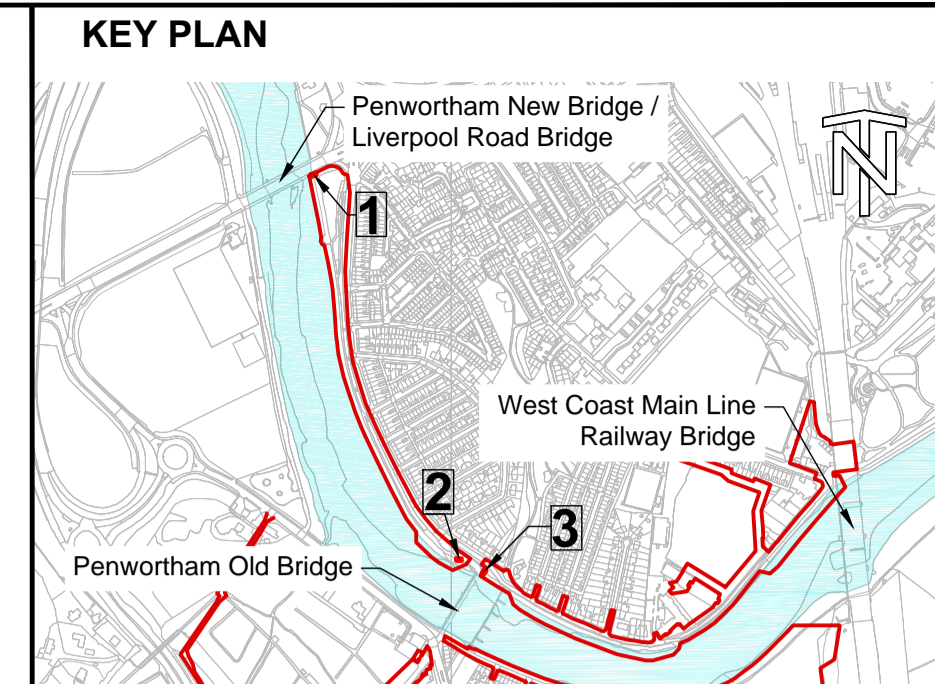

GENERAL NOTES

- ALL DIMENSIONS ARE IN MILLIMETRES UNLESS NOTED OTHERWISE.
- FOR ALL NOTES REFER TO DRG ENV000009C-JAC-ZZ-41A-DR-PL-0001 AREA 1A GENERAL ARRANGEMENT PLAN SHEET 1 OF 3 AND DRG ENV000009C-JAC-ZZ-41B-DR-PL-0001 AREA 1B GENERAL ARRANGEMENT PLAN SHEET 1 OF 3.

REFERENCES

- ENV000009C-JAC-ZZ-41A-DR-PL-0001/0003 AREA 1A GENERAL ARRANGEMENT PLAN SHEET 1/3 OF 3.
- ENV000009C-JAC-ZZ-41B-DR-PL-0001 AREA 1B GENERAL ARRANGEMENT PLAN SHEET 1 OF 3.

LEGEND

- PRECAST CONCRETE WALL
- EXISTING STRUCTURE
- FOUNDATION OUTLINE
- INSITU REINFORCED CONCRETE WALL
- LAND REQUIRED TO UNDERTAKE DEVELOPMENT
- PILLARS
- GLASS PANELS

TOC=TOP OF CONCRETE
TOD=TOP OF DEFENCE
TOF=TOP OF FOUNDATION

P01	2020-11-16	For Planning	MF	APR	NP	MW
Rev	Rev. Date	Purpose of revision	Orig	Check'd	Rev'd	Apprv'd



Project: Preston & South Ribble Flood Risk Management Scheme

Drawing title: Area 1 Tie-in Details Sheet 1 of 3

Drawing status: S4 - Suitable for stage approval Suitability: S4
Scale: @ A1 DO NOT SCALE

Jacobs No.: B550B008 Rev
Client No.: ENV000009C P01

Drawing number: ENV000009C-JAC-DW-41X-DR-PL-0002

© Copyright 2020 Jacobs UK Limited. The concepts and information contained in this document are the property of Jacobs. Use or copying of this document in whole or in part without the written permission of Jacobs constitutes an infringement of copyright. Limitation: This drawing has been prepared on behalf of, and for the exclusive use of, Jacobs' Client, and is subject to, and issued in accordance with, the provisions of the contract between Jacobs and the Client. Jacobs accepts no liability or responsibility whatsoever for, or in respect of, any use of, or reliance upon, this drawing by any third party.

