

HIMALAYAN BALSAM MANAGEMENT PLAN

Version 1 – September 2023



Introduction

This Management Plan has been developed in response to Condition No22 of Planning Approval LCC/2021/0006:

Condition No. 22: No development shall commence until an invasive species management plan to ensure no further spread and eradication of any new areas of growth of Himalayan Balsam within the site has been submitted to and approved in writing by the County Planning Authority.

Himalayan Balsam has been identified within the following Ecological Appraisal, which formed part of the supporting documentation for planning approval LCC/2021/0006:

Envirotech Ecological Consultants, Ref: 5022: Preliminary Ecological Appraisal, Clearwater Fisheries – Northern Area,, Kellet Lane, Carnforth, 04/11/2020

The description within the report is as follows:-

BTN11: Himalayan balsam

Beyond the fenceline to the west of the woodland was a dry ditch, along the dry ditch were occasional stands of Himalayan balsam (Impatiens glandulifera). Himalayan balsam was also recorded on a spoil mound which was present within the now area of bare ground during a previous site visit.

HIMALAYAN BALSAM MANAGEMENT PLAN

Version 1 – September 2023

Site Name:	Clearwater Fisheries
Site Manager:	Michael Pennington
Address:	Clearwater Fisheries, Kellet Lane, Over Kellet LA6 1FQ
Telephone:	01524 745848
Email:	michael.pennington@clearwaterfisheries.co.uk
Persons involved:	Site Manager
Site designation: <i>Establish if there is a requirement to apply for a license/notify before proceeding with plan.</i>	None.

Monitoring and evaluation	
Task	Date
1 Carry out site survey to determine locations of Himalayan balsam. Update distribution map showing locations.	April / May
2 Carry out Actions as detailed below to remove Himalayan balsam.	April / May
3 Monitor site following Himalayan balsam removal to determine locations of any areas of regrowth.	June / October
4 Remove any areas of late season regrowth carefully as per Note1 below.	June / October
5. Repeat monitoring / evaluation on a yearly basis to manage Himalayan balsam growth.	Annually

Actions		
Management options	Responsibility	Date to undertake
A. Mechanical / physical control (Preferred option): Ideally, removal by hand pulling to remove entire plant including shallow root. Where access is difficult, strim / cut back below lowest node to prevent regeneration (leaving the root intact will lead to regrowth). Dispose to registered landfill or dedicated onsite compost heap (covered with tarpaulin).	Site Manager	April to May (prior to seedheads developing)

B. Chemical control: Careful treatment with glyosphate weed killer, ideally using a weed wiper for targetted treatment (minimising the impact on other surrounding plants).	Site Manager	April to May (prior to seedheads developing)
Note 1: Plants found later in the year which have developed seedheads should have heads bagged to prevent seed spread prior to hand pulling.		

Appendix A



Existing site plan pre-development showing reported Himalayan balsam locations.

Appendix B

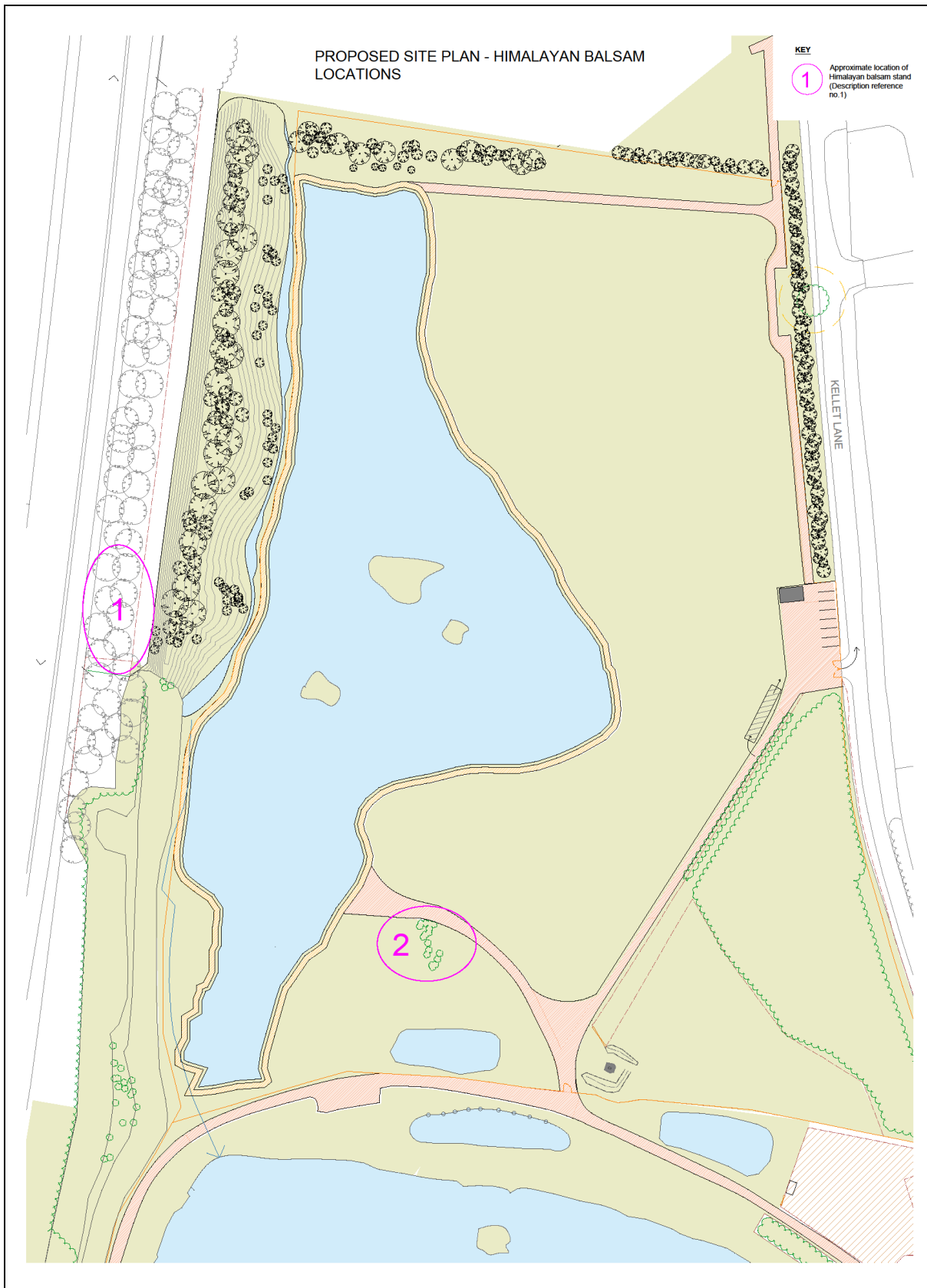

Proposed site plan post-development showing reported Himalayan balsam locations.

Appendix C



Extract map from Envirotech Preliminary Ecological Appraisal. Reported locations of Himalayan Balsam shown noted "11".