

LYTHAM GREEN DRIVE GOLF CLUB Landscape Proposals Plan

LANDSCAPE SPECIFICATION NOTES FOR PREPARATION AND PLANTING

(Generally to BS 4428:1989 - General Landscape Operations; excluding hardworks)

- General:**
- Site preparation for Soils: Where required all existing topsoil and subsoil shall be stripped and stored separately on site. Heaps must not exceed 3m in height and should be used within 12 months in accordance with BS 4425 (Code of practice for general landscape operations).
 - Soil Preparation: Where soil is to be retained, relatively undisturbed and where new planting vegetation on site is taking place, then compaction shall be avoided and pH testing carried out for specific species suitability, and may require addition of biochar, compost, organic fertiliser and/ or native soil.

Grass Seeding

- All areas to receive shall be clear of debris and the like.
- All areas to receive grass seed shall be cultivated and brought to a fine tilth by raking and harrowing within the top 25mm. All debris, including stones of 25mm or over, brought to the surface shall be removed off site.
- Areas of amenity grass seed mix shall receive a suitable fertiliser, seven to ten days prior to seeding. Wild flower/grass seed mix shall not receive any fertiliser.
- The specified seed mix shall be sown at the supplier's recommended rate (between 5 and 35 grams per m²). The quantities of seed shall be divided in half, and sown evenly in transverse directions. The seed shall not be drilled. After sowing the seed shall be lightly harrowed or hand raked into the immediate surface and lightly rolled.
- Areas of amenity grass seed mix shall receive a pre-emergent herbicide applied immediately after seeding.
- When amenity grass mix is 100mm high it shall be lightly tipped by approximately 25mm with an approved mower.

- Any areas which fail to germinate shall be re-cultivated and re-seeded, within one month of the original seeding.
- Areas of broad leaved weeds shall be cleared by either hand pulling or spot treatment using a selective broadleaf herbicide.

Trees:

All trees to be supplied and planted in accordance with British Standards BS 8545:2014, with the nursery providers demonstrating Plant Healthy Certification and/ or an adopted biosecurity policy.

Whips and Transplants

- All whips and transplants shall be supplied and installed with 80mm diameter biodegradable tree guards to transplants with no plastic materials, fixed into ground with pegs. Do not apply to feathered stock.
- All conifers and holly species shall be supplied & installed with 250mm diameter fine mesh guard with 2 no. stakes.
- All stock shall be notch planted with the exception of feathered stock and holly species which shall be pit planted.

Wildflower Seeding: Species Rich Grassland Mix:

- Proposed wildflower grass seed mix, supplied by British Wildflower Seeds with 50% wildflower and 50% grasses.
- To be spread at 4g per m².
- On going maintenance, the wildflower area should be cut once per year, avoiding spring and early summer and autumn.
- Cut vegetation should be removed from the area.
- Meadow should be cut down to 40-60mm above ground level.
- Annual weed control should take place through hand pulling weeds.

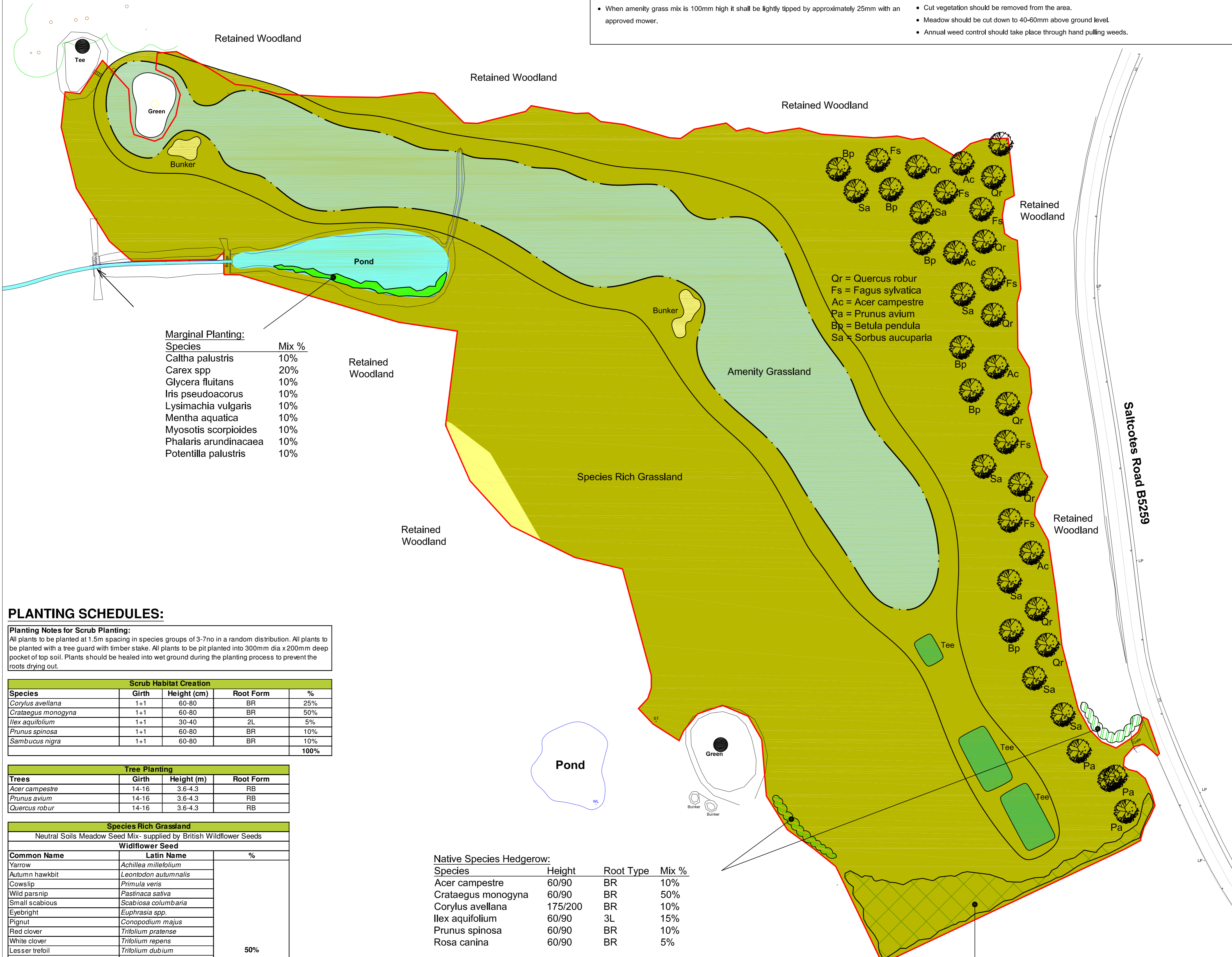

Marginal Planting:

Species	Mix %
<i>Caltha palustris</i>	10%
<i>Carex</i> spp	20%
<i>Glyceria fluitans</i>	10%
<i>Iris pseudoacorus</i>	10%
<i>Lysimachia vulgaris</i>	10%
<i>Mentha aquatica</i>	10%
<i>Myosotis scorpioides</i>	10%
<i>Phalaris arundinacea</i>	10%
<i>Potentilla palustris</i>	10%

PLANTING SCHEDULES:

Planting Notes for Scrub Planting:

All plants to be planted at 1.5m spacing in species groups of 3-7 no in a random distribution. All plants to be planted with a tree guard with timber stake. All plants to be pit planted into 300mm dia x 200mm deep pocket of top soil. Plants should be heeled into wet ground during the planting process to prevent the roots drying out.

Scrub Habitat Creation				
Species	Girth	Height (cm)	Root Form	%
<i>Corylus avellana</i>	1+1	60-80	BR	25%
<i>Crataegus monogyna</i>	1+1	60-80	BR	50%
<i>Ilex aquifolium</i>	1+1	30-40	2L	5%
<i>Prunus spinosa</i>	1+1	60-80	BR	10%
<i>Sambucus nigra</i>	1+1	60-80	BR	10%
				100%

Tree Planting			
Trees	Girth	Height (m)	Root Form
<i>Acer campestre</i>	14-16	3.6-4.3	RB
<i>Prunus avium</i>	14-16	3.6-4.3	RB
<i>Quercus robur</i>	14-16	3.6-4.3	RB

Species Rich Grassland		
Neutral Soils Meadow Seed Mix - supplied by British Wildflower Seeds		
Common Name	Latin Name	%
Yarrow	<i>Achillea millefolium</i>	50%
Ailumn hawkbit	<i>Leontodon autumnalis</i>	
Cowslip	<i>Primula veris</i>	
Wild pansy	<i>Pastinaca sativa</i>	
Small scabious	<i>Scabiosa columbaria</i>	
Eyebright	<i>Euphrasia</i> spp.	
Pignut	<i>Conopodium majus</i>	
Red clover	<i>Tribolium pratense</i>	
White clover	<i>Tribolium repens</i>	
Lesser trefoil	<i>Tribolium dubium</i>	
Sticky Mouse-ear	<i>Cerastium glomeratum</i>	
Common knapweed	<i>Centaurea nigra</i>	
Ox Eye Daisy	<i>Leucanthemum vulgare</i>	
Black medic	<i>Medicago lupulina</i>	
Ribwort plantain	<i>Plantago lanceolata</i>	
Hoary plantain	<i>Plantago media</i>	
Selheal	<i>Prunella vulgaris</i>	
Meadow buttercup	<i>Ranunculus acris</i>	
Yellow rattle	<i>Rhinanthus minor</i>	
Grasses		
Common bent	<i>Agrostis capillaris</i>	50%
Meadow foxtail	<i>Aloperceris pratensis</i>	
Crested dog's tail	<i>Cynosurus cristatus</i>	
Cocksfoot	<i>Dactylis glomerata</i>	
Fescue sp	<i>Festuca</i> sp.	
Timothy	<i>Phleum</i> sp.	
Yorkshire fog	<i>Holcus lanatus</i>	
Quaking grass	<i>Briza media</i>	
Soft brome	<i>Bromus mollis</i>	
		100%

Amenity Species Grassland		
A13 Golf Roughs & Habitat Areas: supplied by Germinal		
Common Name	Latin Name	%
Browntop bentgrass	<i>Agrostis capillaris</i>	3%
Chewings fescue	<i>Festuca rubra commutata</i>	25%
Creeping red fescue	<i>Festuca rubra rubra</i>	63%
Sheeps fescue	<i>Festuca ovina</i>	10%
		100%

Native Species Hedgerow:

Species	Height	Root Type	Mix %
<i>Acer campestre</i>	60/90	BR	10%
<i>Crataegus monogyna</i>	60/90	BR	50%
<i>Corylus avellana</i>	175/200	BR	10%
<i>Ilex aquifolium</i>	60/90	3L	15%
<i>Prunus spinosa</i>	60/90	BR	10%
<i>Rosa canina</i>	60/90	BR	5%

Native Scrub Habitat Creation:

Species	Girth	Height	Root Type	Mix %
<i>Corylus avellana</i>	1+1	60/80	BR	25%
<i>Crataegus monogyna</i>	1+1	60/80	BR	45%
<i>Ilex aquifolium</i>	1+1	30/40	BR	5%
<i>Prunus spinosa</i>	1+1	60/80	3L	10%
<i>Sambucus nigra</i>	1+1	60/80	BR	10%
<i>Ulex europaeus</i>	-	30/50	2L	5%

Landscape Management:

Habitats and planting to be managed in accordance with the Biodiversity Net Gain Report dated February 2024 by Appletons. This will be carried out as part of the regular landscape maintenance of the golf course.

REVISIONS	
No.	Description

Project LYTHAM GREEN DRIVE GOLF CLUB		Scale 1:750@A1
Title Landscape Proposals Plan		
Client Booth Ventures Ltd.		Drawing No. 2419_03
Date FEBRUARY 2024	Drawn SW	
Checked DS	Revision	Status Planning-Final

KEY:

- Site Application Boundary
- Existing Ponds
- Proposed Species Rich Grassland seed mix
- Proposed Amenity Species seed mix
- Marginal Planting
- Proposed Hedgerows

