

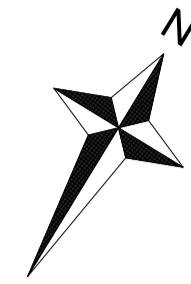

Scale 1:100 @ A1



Note:-
All construction elements shown on this scheme may be subject to change.

Drawing is indicative and subject to measured survey

HEALTH & SAFETY COMMENTS
 CDM REGULATIONS The client must abide by the Construction Design and Management Regulations 2015 which relate to any building works which:
 a. Lasts longer than 30 working days and has more than 30 working working simultaneously at any point in the project OR
 b. Exceeds 500 person days
 Asbestos survey to be undertaken prior to commencement of works

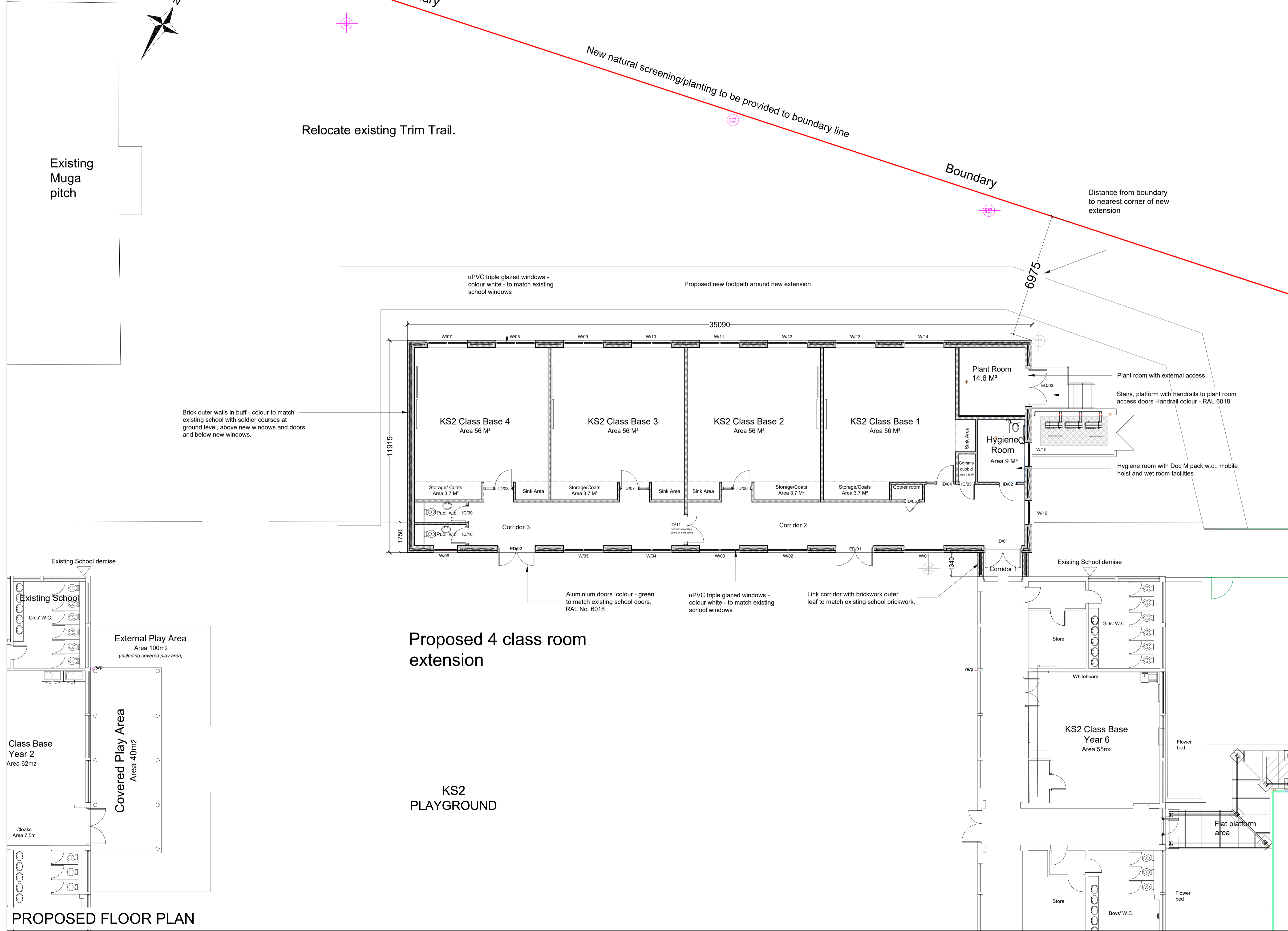

Proposed 4 class room extension

KS2 PLAYGROUND

PROPOSED FLOOR PLAN

DATE	REV	NOTES
20/12/23	S4-P02	Altered to 4 classrooms. Location moved away from boundary.
24/07/23	S4-P01	Planning issue

NOTE: DIMENSIONS ARE NOT TO BE SCALED FROM THIS DRAWING. ALL WRITTEN MEASUREMENTS ARE TO BE CHECKED ON SITE BY THE CONTRACTOR.
 © LANCASHIRE COUNTY COUNCIL 2023
 ALL RIGHTS DESCRIBED IN CHAPTER IV OF THE COPYRIGHT, DESIGN AND PATENTS ACT 1988 HAVE BEEN GENERALLY ASSERTED.

TOWN NAME
Lea, Preston
 PREMISES NAME
Lea Community Primary School

PROJECT
**Phase 2
Proposed Extension**

DRAWING TITLE
**Proposed floor plan
Planning issue**

SCALE:	DRAWN BY	DATE	CHECKED BY
1:100 1:200	@A1 @A3 SO'L	23/06/23	LC



Asset Management Service

DESIGN & CONSTRUCTION,
 LANCASHIRE COUNTY COUNCIL,
 PO BOX 100, PR1 0LD. TEL: 0300 1236701

PROJECT NO.	DRAWING NO.	REVISION
133336 - LCC	P2-ZZ-DR-A-40_50_63-0005	S4-P02

DRAWING STATUS
Planning issue