

EXISTING VEHICLE ACCESS GATES SCALE 1:200 @ A1 SHEET

0 2 4 6 8 10m @1:200 SCALE

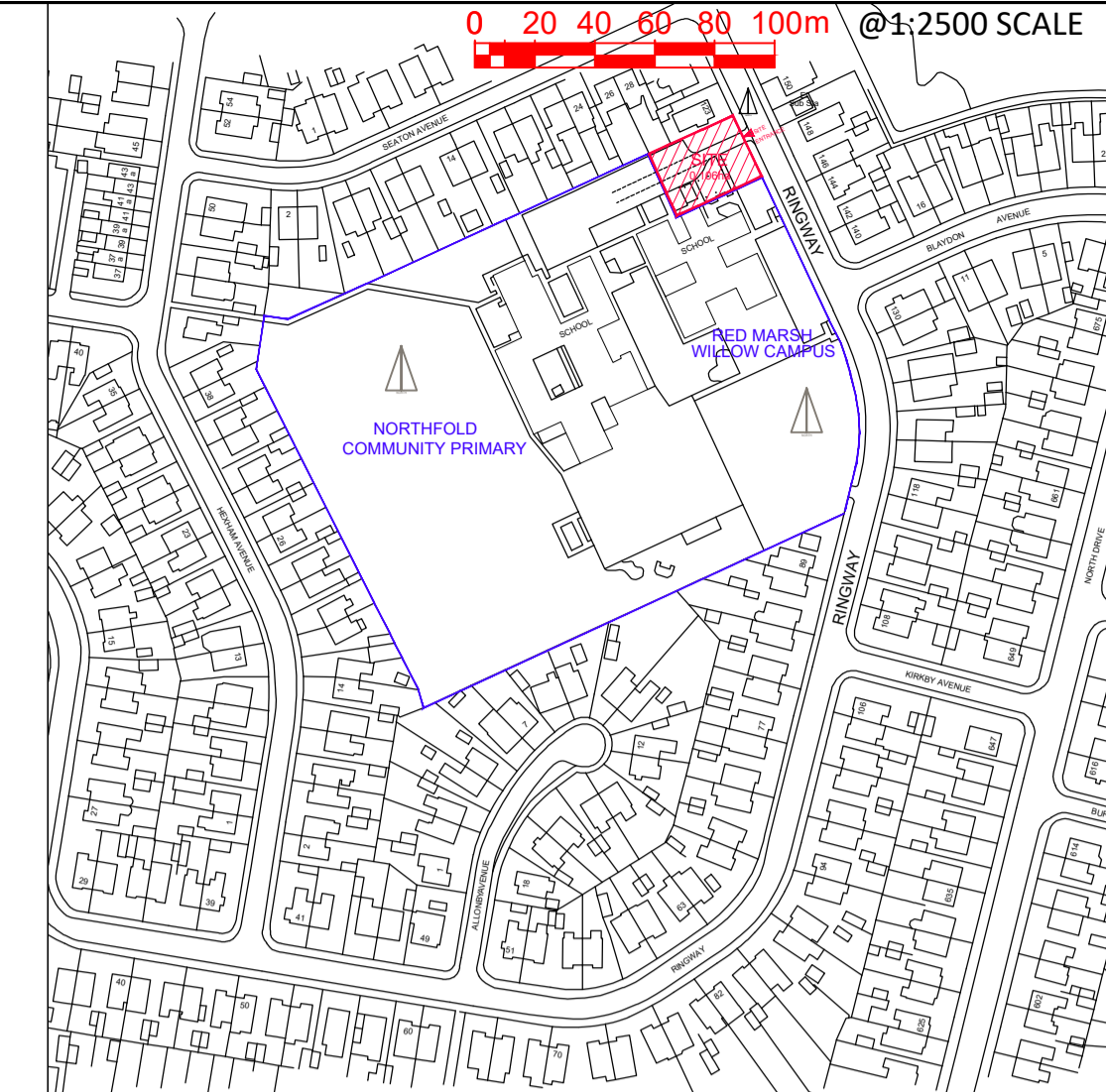
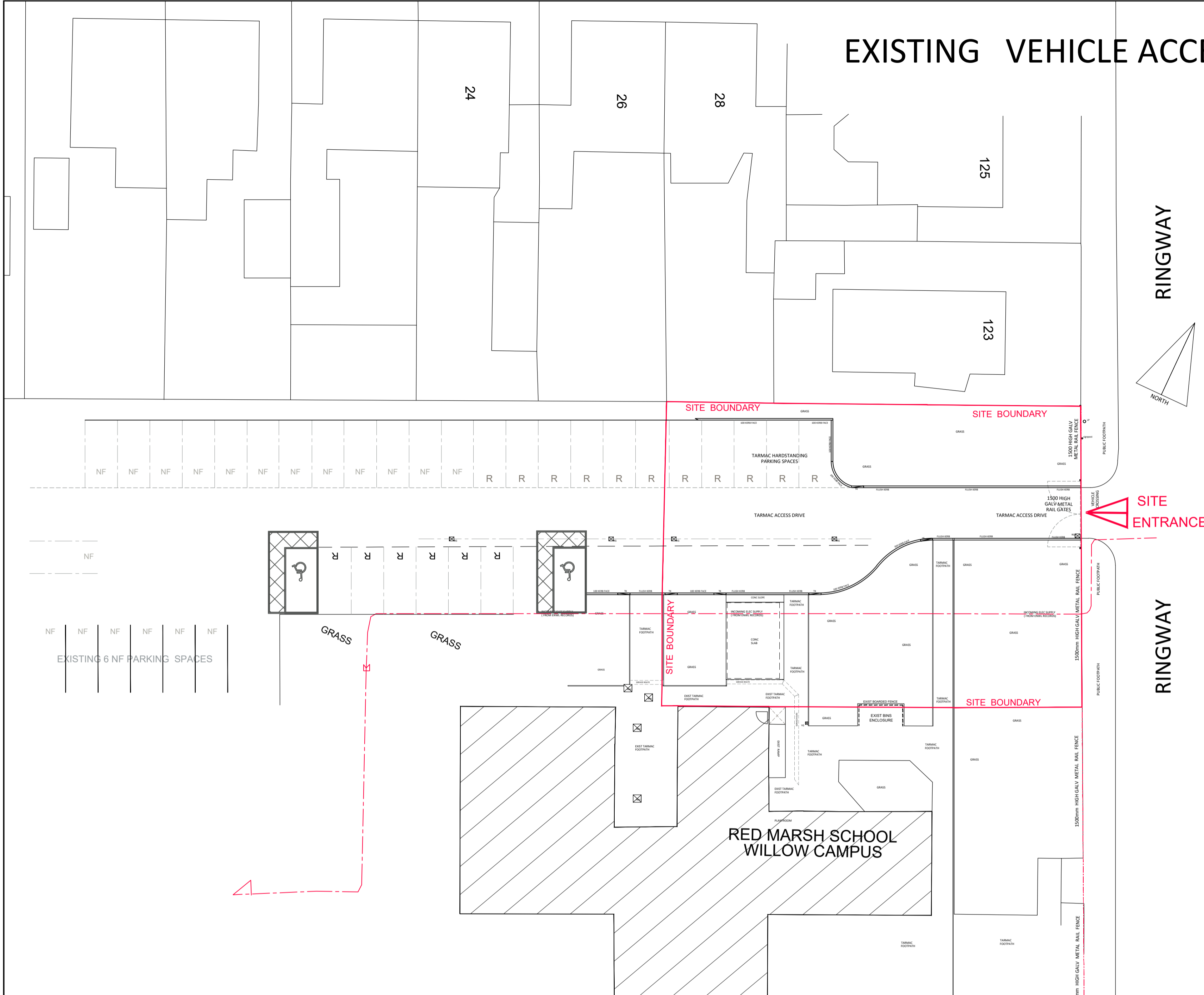

KEY PLAN - 1:2500 SCALE FOR IDENTIFICATION PURPOSES ONLY

HEALTH & SAFETY COMMENTS
 REFER TO SITE H&S FILE FOR ALL RAMS.
 INCOMING ELECTRIC MAINS SUPPLY ROUTE KNOWN TO BE IN VICINITY OF NEW TURNING HEAD WORKS - SEE SERVICE RECORD PLANS. CAT CABLE DETECTION PROCESS TO BE DONE PRIOR TO ANY EXCAVATION WORKS BEING UNDERTAKEN ON SITE.

0 20 40 60 80 100m @1:2500 SCALE
 0 2 4 6 8 10m @1:200 SCALE

DATE	REV	NOTES
30.01.24	S2-C1	ISSUED FOR PLANNING INFORMATION



EXISTING FRONTAGE AND VEHICLE ACCESS GATES - AS VIEWED FROM RINGWAY AND SITE ACCESS ROAD

NOTE: DIMENSIONS ARE NOT TO BE SCALED FROM THIS DRAWING. ALL WRITTEN MEASUREMENTS ARE TO BE CHECKED ON SITE BY THE CONTRACTOR.
 © LANCASHIRE COUNTY COUNCIL MMXVII
 ALL RIGHTS DESCRIBED IN CHAPTER IV OF THE COPYRIGHT, DESIGN AND PATENTS ACT 1988 HAVE BEEN GENERALLY ASSERTED.

TOWN NAME
THORNTON CLEVELEYS

PREMISES NAME
RED MARSH SCHOOL WILLOW CAMPUS Ringway FY5 2NL

PREMISES NO.
 02 - 142

PROJECT
RedMarsh -Willow Campus Phase2 Refurbishment

DRAWING TITLE
EXISTING SITE ACCESS

SCALE @ A2 1:200@A1	DRAWN BY AGH	DATE 30.01.24	CHECKED BY LAC
------------------------	-----------------	------------------	-------------------

Lancashire County Council

Design & Construction

DESIGN & CONSTRUCTION,
 LANCASHIRE COUNTY COUNCIL,
 PO BOX 100, PR1 0LD. TEL: 0300 1236701

PROJECT NO. 12653	DRAWING NO. A30-14-0008	REVISION S2-C1
----------------------	----------------------------	-------------------

DRAWING STATUS
PLANNING